

Intensive Japanese Programs

履修案内

Fall and Winter Terms

2020

令和2年度秋～冬学期



Center for Japanese Language and Culture
Osaka University

大阪大学日本語日本文化教育センター

INTENSIVE JAPANESE PROGRAMS

Fall and Winter Terms

2020

Contents

Academic Calendar	v
Academic Calendar Fall and Winter Terms, 2020	v
Intensive Japanese Programs, CJLC	2
1. Types of Programs	2
2. Classes	2
3. Examinations and Academic Record	4
4. Approval of Completion	6
5. Subject Registration	8
6. Operation of the CJLC Office	10
7. CJLC Library and Computer Lounge	12
8. Forms of Certificates	14
9. Cancellation of Classes due to weather warnings, disasters, and suspension of public transportation	16
Undergraduate Students Program [U]	18
1. Program Outline	18
2. Requirements for [U] Program Certificate	18
3. Outline of Subjects	20
3-1. Japanese Language Subjects	22
3-2. Required Subjects Other than Japanese Subjects	24
4. Entrance into University	26
Japanese Studies Program [J]	28
1. Program Outline	28
2. Requirements for [J] Program Certificate	32
3. Outline of Subjects	34
3-1. Required Subjects	34
3-2. Electives	34
4. Extracurricular Activities	46
Maple Program [M]	48
1. Program Outline	48
2. Requirements for [M] Program Certificate	52
3. Outline of Subjects	54
3-1. Required Subjects	54
3-2. Electives	56
4. Extracurricular Activities	68

OU Foundation Program [F]	70
1. Program Outline	70
2. Requirements for [F] Program Certificate	72
3. Outline of Subjects	76
3-1. Japanese Language Subjects	76
3-2. Subjects Other Than Japanese Language	84
List of Classes	88
Weekly Schedule	94
Abbreviations	104
Minoh Campus Map	106
CJLC Building	109
Advisors	113

ねんど がくねんれき
2020年度 学年暦 Academic Calendar 2020
《Uプログラム (U Program)》

2020年	日	月	火	水	木	金	土
4月	5	6	7	8	9	10	11
April	12	13	14	15	16	17	18
	19	20	21	22	23	24	25
	26	27	28	29	30		
5月	祝日	祝日	祝日	振替休日		1	2
3	4	5	6	7	8	9	
May	10	11	12	13	14	15	16
	17	18	19	20	21	22	23
	24	25	26	27	28	29	30
	31						
6月		①	①	①	①	①	
	1	2	3	4	5	6	
June	7	8	9	10	11	12	13
	14	15	16	17	18	19	20
	21	22	23	24	25	26	27
	28	29	30				
7月				⑤	⑤	⑤	4
	5	6	7	8	9	10	11
July	12	13	14	15	16	17	18
	19	20	21	22	祝日	祝日	25
	26	27	28	29	30	31	
8月							1
	2	⑩	⑩	⑩	⑨	⑨	8
August	9	祝日	⑪	⑪	⑩	⑩	15
	16	17	18	19	20	21	22
	23	24	25	26	27	28	29
	30	31					
9月			1	2	3	4	5
	6	①	①	①	①	①	12
September	13	②	②	②	②	②	19
	20	祝日	祝日	③	③	③	26
	27	③	③	④			

2020年	日	月	火	水	木	金	土
10月	4	5	6	健康診断	7	8	9
October	11	12	13	14	15	16	17
	18	19	20	21	22	23	24
	25	26	27	28	29	30	31
11月	1	2	3	祝日	4	5	6
8	9	10	11	12	13	14	
November	15	16	17	18	19	20	21
22	23	24	25	26	27	28	
	29	30					
12月				⑪	⑫	⑬	⑭
	1	2	3	4	5		
December	6	7	8	9	10	11	12
	13	14	15	16	17	18	19
	20	21	22	23	24	25	26
	27	28	29	30	31		
2021年						祝日	1
January	3	4	5	6	7	8	9
	10	11	12	13	14	15	16
	17	18	19	20	21	22	23
	24	25	26	27	28	29	30
	31						
2月				⑯	⑰	⑱	⑲
	1	2	3	4	5	6	
February	7	8	9	補講	祝日	⑳	13
	14	15	16	17	18	19	20
	21	22	23	24	25	26	27
	28						
3月		㉒	㉓	再試験			
	1	2	3	4	5	6	
March	7	8	9	10	11	12	13
	14	15	16	17	18	19	祝日
	21	22	23	24	25	26	27
	28	29	30	31			

秋～冬学期 Fall and Winter Terms

9月14日～30日	オリエンテーション・プレースメントテスト
September 14th - 30th	Orientation / Placement Tests
10月7日	健康診断(休講)
October 7th	Medical Checkup (No Classes)
10月30日～11月10日	履修登録確認期間
Oct 30th - Nov 10th	Class Registration Confirmation Period
11月21日～22日	大学祭
November 21st - 22nd	University Festival
11月27日～12月10日	12月試験
Nov 27th - Dec 10th	December Examination
12月11日, 15日	進学相談 / 再試験
Dec 11th, 15th	Consultation on entrance into university / Make-up Exams
12月24日～1月3日	冬休み
Dec 24th - Jan 3rd	Winter Holidays
2月10日	補講
February 10th	Make-up Classes
2月16日～3月2日	最終試験
Feb 16th - Mar 2nd	Final Examination
3月3日	再試験
March 3rd	Make-up Examinations
3月9日	修了式
March 9th	Closing Ceremony
<祝日 休日 Public Holidays>	
4月29日	昭和の日
April 29th	Shōwa Day
5月3日～6日	憲法記念日、みどりの日、子供の日、振替休日
May 3rd - 6th	Constitution Memorial Day, Greenery Day, Children's Day, Substitute Holiday
7月23日, 24日	海の日、スポーツの日
July 23rd, 24th	Marine Day, Sports Day
8月10日	山の日
August 10th	Mountain Day
9月21日, 22日	敬老の日、秋分の日
September 21st, 22nd	Respect for the Aged Day, Autumnal Equinox Day
11月3日	文化の日
November 3rd	Culture Day
11月23日	勤労感謝の日
November 23rd	Labour Thanksgiving Day
1月1日	元日
January 1st	New Year's Day
1月11日	成人の日
January 11th	Coming-of-age Day
2月11日	建国記念の日
February 11th	National Foundation Day
2月23日	天皇誕生日
February 23rd	Emperor's Birthday
3月20日	春分の日
March 20th	Vernal Equinox Day

	授業日 Classes
	補講日 Make-up Classes
	試験日 Examinations

2020 年度 学年暦

Academic Calendar 2020

《 J/M/F プログラム (J/M/F Program) 》

ようび 曜日(Day) つき 月(Month)	にち 日	げつ 月	か 火	すい 水	もく 木	きん 金	ど 土
	Sun.	Mon.	Tue.	Wed.	Thu.	Fri.	Sat.
10月 October					① 1	① 2	3
	4	① 5	① 6	健康診断 7	② 8	② 9	10
	11	② 12	② 13	① 14	③ 15	③ 16	17
	18	③ 19	③ 20	② 21	④ 22	④ 23	24
	25	④ 26	④ 27	③ 28	⑤ 29	⑤ 30	31
11月 November	1	⑤ 2	祝日 3	④ 4	⑥ 5	⑥ 6	7
	8	⑥ 9	⑤ 10	⑤ 11	⑦ 12	⑦ 13	14
	15	⑦ 16	⑥ 17	⑥ 18	⑧ 19	⑧ 20	大学祭 21
	22	大学祭 祝日 23	⑦ 24	⑦ 25	⑨ 26	⑨ 27	28
	29	⑧ 30					
12月 December			⑧ 1	⑧ 2	⑩ 3	⑩ 4	5
	6	⑨ 7	⑨ 8	⑨ 9	⑪ 10	⑪ 11	12
	13	⑩ 14	⑩ 15	⑩ 16	⑫ 17	⑫ 18	19
	20	⑪ 21	⑪ 22	⑪ 23	24	25	26
	27	28	29	30	31		
2021年 1月 January						祝日 1	2
	3	⑫ 4	⑫ 5	⑫ 6	⑬ 7	⑬ 8	9
	10	祝日 11	⑬ 12	⑬ 13	補講 14	補講 15	16
	17	⑬ 18	⑭ 19	⑭ 20	⑭ 21	⑭ 22	23
	24	⑭ 25	⑮ 26	⑮ 27	⑮ 28	⑮ 29	30
	31						
2月 February		⑮ 1	特別授業 2	3	4	5	6
	7	特別授業 8	9	10	祝日 11	12	13
	14	15	16	17	18	19	20
	21	22	祝日 23	24	25	26	27
	28						
3月 March		1	2	3	4	5	6
	7	8	9	10	11	12	13
	14	15	16	17	18	19	祝日 20
	21	22	23	24	25	26	27
	28	29	30	31			

あき ふゆがつき
秋～冬学期 Fall and Winter Terms

- 10月7日
October 7th
健康診断(休講)
Medical Checkup (No Classes)
- 10月30日～11月10日
Oct 30th - Nov 10th
履修登録確認期間
Class Registration Confirmation Period
- 11月21日～22日
November 21st - 22nd
大学祭
University Festival
- 12月24日～1月3日
Dec 24th - Jan 3rd
冬休み
Winter Holidays
- 1月14日, 15日
January 14th, 15th
補講
Make-up Classes
- 1月19日～2月1日
Jan 19th - Feb 1st
最終試験
Final Examination
- 2月9日～3月31日
Feb 9th - Mar 31st
春休み
Spring Holidays

しゅくじつ
<祝日 Public Holidays>

- 11月3日
November 3rd
文化の日
Culture Day
- 11月23日
November 23rd
勤労感謝の日
Labour Thanksgiving Day
- 1月1日
January 1st
元日
New Year's Day
- 1月11日
January 11th
成人の日
Coming-of-age Day
- 2月11日
February 11th
建国記念の日
National Foundation Day
- 2月23日
February 23rd
天皇誕生日
Emperor's Birthday
- 3月20日
March 20th
春分の日
Vernal Equinox Day

 じゅぎょうび
授業日 Classes

 ほこうび
補講日 Make-up Classes

 しけんび
試験日 Examinations

Intensive Japanese Programs

1. Types of Programs

The Center for Japanese Language and Culture, Osaka University, offers various short-term intensive Japanese programs, mainly for Monbu-kagaku-sho (MEXT) scholarship students. They are categorized into the following programs according to the content. Each program is described in detail in its proper section.

- ① Undergraduate Students Program [U] (enrolled in April, one-year program)
- ② Japanese Studies Program [J] (enrolled in October, one-year program)
- ③ Maple Program [M] (enrolled in October, one-year program)
- ④ OU Foundation Program [F]
(enrolled in October, half-year program)

2. Classes

(1) Terms

There are four terms (two semesters) each year: Spring and Summer Terms (Spring Semester) (April 1 to September 30) and Fall and Winter Terms (Fall Semester) (October 1 to March 31 of the following year). Classes in J and M programs are given for 30 weeks a year : 15 weeks each in spring and fall semesters, and in U program, for 35 weeks a year. Also, classes in F program are given for 15 weeks only in fall semester.

(2) Class meeting times

There are five 90-minute time periods, each day from Monday to Friday.

Period	Class meeting times
1st Period	8:50 a.m. – 10 : 20 a.m.
2nd Period	10 : 30 a.m. – 12 : 00 p.m.
3rd Period	1 : 30 p.m. – 3 : 00 p.m.
4th Period	3 : 10 p.m. – 4 : 40 p.m.
5th Period	4 : 50 p.m. – 6 : 20 p.m.

(3) Credit hours

According to the type of course, credit hours are prescribed as follows:

Category	Lecture/Seminar		Category	Recitation	
Credit hours	Class: 15 credit hours	Private study: 30 credit hours	Credit hours	Class: 30 credit hours	Private study: 15 credit hours

(4) Cancellation of classes

Cancellation of a class will be announced on the bulletin board near the office of the CJLC Office. Be sure to check the bulletin board before attending a class.

When the instructor in charge does not appear in the classroom within 30 minutes from the start time of the class and there is no cancellation notice on the bulletin board, please contact the CJLC Office and follow its instructions.

Classes may be cancelled when public transportation service is suspended or a storm warning as well as an emergency warning are issued. Please refer to the Guidelines for Cancellation of Classes due to weather warnings, disasters, and suspension of public transportation (see p.16) to see whether classes will be cancelled.

(5) Supplementary classes

Supplementary classes may be held to make up for a delay in progress or a cancelled class. Information on supplementary classes will be given directly by the instructor in charge and posted on the bulletin board.

(6) Attendance

In the Intensive Japanese Programs offered by the CJLC, if the attendance rate of a student falls below 80%, the student will not be able to successfully complete the program. If you will be or were absent from a class through unavoidable circumstances, you must submit a Notice Report of Absence to the CJLC Office, where Notice Report of Absence forms are available. The Notice Report of Absence must be submitted before such absence or at least one week after it, along with evidence to prove the unavoidability.

3. Examinations and Academic Record

(1) Examinations

Evaluation methods include written and oral examinations, reports, papers, practical and other examinations. For some courses, the rate of attendance and marks in unscheduled examinations are also reflected in grading, or substituted for marks in scheduled examinations. For the evaluation method of each course, see the volume Syllabus through KOAN.

● Matters to note regarding examinations

- ① Information on scheduled examinations is posted on the bulletin board. For examinations other than scheduled ones, the instructor in charge will make an oral announcement. Since the announcements on examinations are subject to change, please check the bulletin board from time to time.
- ② The subjects for which scheduled examinations will be held will be announced two weeks prior to the first day of the examination period as a rule. The schedule and details of the examinations will be announced one week before the beginning of the examination period.
- ③ If you appear in the classroom later than 30 minutes from the start time of the examination, you will not be allowed to take the examination. Be careful not to be late for an examination. Students may leave the classroom 45 minutes from the start time of an examination.
- ④ If a student is caught cheating or doing other unfair conduct in an examination, he/she should immediately stop the test, and his/her registration for the subject will be cancelled. Students guilty of unfair conduct will be subjected to disciplinary action in accordance with the school regulations.
- ⑤ If you cannot take an examination through unavoidable circumstances, submit a Notice of Absence to the CJLC Office, where Notice of Absence forms are available.
- ⑥ Taking an examination in a subject for which you have not been registered will not receive credit.

(2) Grading

Achievement in each subject is evaluated as Grade S, A, B, C, or F as shown in the table below:

Assessment	Passed				Failed
Grade	S	A	B	C	F
Score (out of 100)	100-90 scores	89-80 scores	79-70 scores	69-60 scores	59-0 scores

(3) Notification of grades

The grades in subjects for which students have registered are notified by delivering a report card to each student after the closing ceremony.

4. Approval of Completion

(1) Requirements for a certificate

It is necessary to complete all the subjects required in the program. For details, such as the titles of subjects and the numbers of required subjects and electives, see the program descriptions given later.

The approval/disapproval of completion of courses is announced in September for the August and summer terms and in March for the fall and winter terms.

(2) Certificate of Completion

Certificates will be issued to students who satisfy all the requirements for completion of the program in the prescribed manner.

5. Subject Registration

(1) Placement: Evaluation of degree of proficiency in Japanese

To register for the subjects offered by the CJLC, students need to be evaluated for their degree of proficiency in Japanese. The evaluation is done through a placement test. You can take grammar, Kanji and composition test at the CJLC website. The schedule and location of interview test will be posted on the bulletin board near the CJLC Office.

(2) Explanatory meeting for registration (Orientation Sessions by Program)

At the beginning of each term, meetings are held to give explanations on subject registration. All the students are required to attend the meetings, where textbooks and other materials for designated classes of required subjects may be handed out. The schedule and location of Orientation Sessions by program will be announced on the bulletin board near the CJLC Office.

(3) Registration

Subjects should be registered for every term.

If you fail to register for a subject, you will not be graded for the subject or considered to have completed the subject, even if you attend the class. Any corrections in the subject registration forms should be made within the registration period. Take care in preparing and submitting your registration form.

The last day of the registration period is usually about two weeks after the beginning of classes. After the deadline, registrations will not be accepted. Be sure to finish subject registration at the CJLC Office within the registration period. (Registration by mail fax or e-mail will not be accepted.)

● Matters to note regarding subject registration

- ① You cannot register for a course which is not a designated subject.
- ② For some subjects, students are allowed to register for designated courses only. At the Orientation Sessions by Course mentioned in section (2) above, information will be given about important matters in registration. Be sure to pay attention to this information and follow the instructions in registering for subjects.
- ③ After the deadline of the subject registrations, receive your Subject Registration Confirmation at the CJLC Office during the Subject registration confirmation period, and double-check that all requirements have been completed. You must return your signed Subject Registration Confirmation to the CJLC Office, whether or not there are any corrections.

(4) Paper of completion course

In some programs/courses, students are required to submit a paper for completion of the course. In accordance to the instructions in the program/course descriptions given later, submit the paper by the deadline.

6. Operation of the CJLC Office

(1) Office hours

The location and office hours of the CJLC Office are as follows :

※ Monday-Friday (holidays excluded)

Location	1st floor, Center for Japanese Language and Culture Building	
Office hours	a.m.	10:00 - 11:30
	p.m.	12:30 - 4:30

N.B. Unscheduled closures or changes in the office hours will be announced on the bulletin board.

(2) Communication of curriculum-related information

All curriculum-related information, such as on classes and examinations, will be communicated through the bulletin board. Be sure to check the bulletin board near the office of the CJLC Office before attending a class.

(3) Telephone Inquiries

All information on class cancellations, schedules of school events, classes and examinations is communicated through the bulletin board. Inquiries by telephone will not receive a reply, and neither will inquiries about an instructor's address or telephone number.

(4) Certificates

For student-related certificates, apply to the CJLC Office, using a Request for Certificate form. A certificate will be issued seven days from the date of application, as a rule. Around the end of the semester (March), when many students make applications, it may take 10 days or so.

Regarding student-related certificates issued at the CJLC Office, please refer to page 14.

① Transcript / Academic Record

② Certificate of Program Completion

③ Enrollment Certificate (only for former students who did not complete the course)

7. CJLC Library and Computer Lounge

The CJLC Library and Computer Lounge can be found on the second floor of the Center for Japanese Language and Culture. In addition to general books, you will find various textbooks as well as workbooks on learning Japanese, and there is an area where students can study while listening to CDs and cassette tapes that come with these books.

Regarding Japanese literature material, the library facilitates equipment for viewing audio visual material: genres ranging from entertainment, movies, drama, to anime and so on. In order to find the material that you want to use, search the "Japanese Literature Data and Audio Visual Materials Database" found on the CJLC homepage. Students can use the computers and printers in the Computer Lounge. The user card distributed at orientation is necessary in order to do so.

The CJLC Library and Computer Lounge are open from Monday through Friday, from 10 a.m. to 6:20 p.m. (holidays excluded).

(Note) The CJLC Library and Computer Lounge will be closed temporarily on an as-needed basis.

8. Forms of Certificates

① - 1 For U Program

TRANSCRIPT <small>(Government Sponsored Foreign Student)</small>				No.
Institution		Admission : _____		Date Of Birth: _____
Nationality		Completion : _____		
ID Number	Name	Sex		

Curriculum Class Evaluation			Grade	Hrs Per Week	Grading Scale
Curriculum Class					
Japanese Language	Listening				S: 90 ~ 100 A: 80 ~ 89 B: 70 ~ 79 C: 60 ~ 69 F: 0 ~ 59 N/A: Not Applicable
	Reading				
	Grammar				
	Kanji				
	Oral Presentation				
Japanese Cultural Background					Subject Report
English					
Political Science and Economics					
Japanese History					
Mathematics (Elective)					
Natural Science					
Mathematics					
Chemistry					
Physics					
Biology					

Attendance Record			
Division \ Semester	Spring Semester	Fall Semester	Total
Class Hours			
Hours Absent			
Hours Attended			

N.B. Spring Semester.....April~September
Fall SemesterOctober~March

OFFICIAL SEAL OF THE UNIVERSITY

Director
Center for Japanese Language and Culture
Osaka University

① - 2 For other Programs

Osaka University Transcript			
Name: _____		Date of Birth: _____	
Student Number: _____		Date of Enrollment: _____	

SUBJECT	Credits	Year	Grade

Code: 3123-01, 2123-01, 3173-11, 0123-11, F123, A123/Authorization

Subjects under Academic Major (Major Subjects/Advanced Global Literacy Education) are categorized as Major Subjects.
 Subjects under Global Literacy (Advanced Global Literacy Education/Major Subjects) are categorized as Advanced Global Literacy Education. (Qualify to attend for "Program for Leading Graduate Schools")

This is to certify that the above record is true and correct.

President of Osaka University

Official Seal of
Osaka University

Date:

② Certificate of Program Completion

CERTIFICATE

Program : _____
 Period of Attendance : _____
 Status : _____
 Name : _____
 Sex : _____
 Date of Birth : _____
 Country : _____
 Date of Graduation : _____

This is to certify that the above record is true and correct.

OFFICIAL SEAL OF
Center for Japanese Language and Culture
OSAKA UNIVERSITY

Director
Center for Japanese Language and Culture
Osaka University

③ Enrollment Certificate

CERTIFICATE

Name: _____
 Date of Birth: _____
 Date of Enrollment: _____

This is to certify that the above record is true and correct.

President of Osaka University

Official Seal of
Osaka University

9. Cancellation of classes due to weather warnings, disasters, and suspension of public transportation

(1) Cancellation of classes after issuance of weather warnings

If a “Storm Warning (暴風警報)” or an “Emergency Warning* (特別警報)” is issued for the region including Toyonaka, Suita, Ibaraki, and Minoh cities, classes will be cancelled. If either of these warnings are issued during a class, classes will be cancelled beginning with the next class.

*Classes will be cancelled for an issuance of *any type* of Emergency Warning (特別警報)

(2) Cancellation of classes during suspension of public transportation

If service of one or more of the following lines of public transportation has been suspended (including partial suspension) due to a disaster, natural or man-made, classes held on the campus(es) affected by this suspension will be cancelled.

(1) Toyonaka Campus	Hankyu Railway (Takarazuka Line: Umeda – Takarazuka) or Osaka Monorail (all lines)
(2) Suita Campus	Hankyu Railway (Senri Line: Umeda/Tenjinbashisuji-rokuhome – Kita-senri) or Osaka Monorail (all lines)
(3) Minoh Campus	Hankyu Railway (Senri Line: Umeda/Tenjinbashisuji-rokuhome – Kita-senri), Hankyu Bus (Senri-chuo – Osaka University School of Foreign Studies/Matani jutaku-4) or Osaka Monorail (all lines)

(3) Lifting of weather warnings and/or resumption of public transportation service

If weather warnings are lifted or public transportation services have resumed, classes will be held according to the following chart:

If the warning is lifted or transportation service is resumed...	classes will be...
before 6 am	held all day
after 6 am but before 9 am	held in the afternoon
after 9 am or not at all	cancelled all day

*Confirmation of lifting of weather warnings and/or resumption of public transportation service will be conducted via television, radio, and the internet.

Undergraduate Students Program [U]

1. Program Outline

The Undergraduate Students Program is a preparatory program for international students who come to Japan to study in Japanese universities on the Monbu-kagaku-sho scholarship. The program is designed to help students develop the knowledge and advanced skills in the Japanese language required for academic activities in universities.

This program is intended for students majoring in natural sciences. All the Monbu-kagaku-sho scholars should remember that the certificate issued to them upon successfully completing this program is a prerequisite to admission to their next universities in Japan.

Classes of the Modern Japanese Course start from elementary level, intermediate level, to advanced level. The level from which the student will start his or her class is apt to change depending on his or her Japanese level at the beginning of April. Students are required to enroll in not only Japanese Language subjects and a Japanese Cultural Background class, but also Mathematics, Physics, Chemistry and Biology courses.

2. Requirements for [U] Program Certificate

- ① All the required subjects must be completed.
- ② The minimum rate of attendance for all the required subjects and electives is 80%.
- ③ Examinations are held for all subjects and must be taken during the scheduled examination terms in September, December and February. For the examination terms, see the Academic Calendar.

The average marks of the scheduled examinations must not be lower than 60%.

3. Outline of Subjects

Category	Course			Class hours	
Required	Japanese	Modern Japanese* (Elementary/ Intermediate/ Advanced)	UJPN	11	18
	Japanese Cultural Background		JC	1	
	Mathematics		MATH	2	
	Chemistry		CHEM	2	
Required Electives	Physics		PHYS	2	
	Biology		BIOL	2	

* Modern Japanese Course

- (1) Students will study Elementary Japanese, Intermediate Japanese and Advanced Japanese. The level of Japanese that students will study shall be based according to the student's degree of Japanese proficiency as of April.
- (2) The Advanced Modern Japanese Course contains the following subjects: Grammar & Vocabulary, Kanji & Vocabulary, Listening Comprehension & Academic Listening, Written Presentation, Oral Presentation, and Academic Reading.

3-1. Japanese Language Subjects

Modern Japanese: Elementary Japanese [UJPN]

Eleven class hours per week (90 min. × 11)

Fundamentals of modern Japanese, including grammar (about 200 sentence patterns), vocabulary (about 4,000 words), present-day Japanese writing system and essential Kanji (about 600 Chinese characters), with emphasis on four basic language skills: reading and listening comprehension, speaking, and writing. Small tests of the vocabulary, rhetorical expressions, and Kanji covered in class will be given at the end of every lesson.

Modern Japanese: Intermediate Japanese [UJPN]

Eleven class hours per week (90 min. × 11)

Designed to develop sophisticated skills in modern Japanese through practice and analysis of about 250 basic sentence patterns and 5,000 essential words, with emphasis on reading comprehension and writing. Small tests of the vocabulary and rhetorical expressions covered in class will be given at the end of every lesson.

Modern Japanese: Advanced Japanese [UJPN]

Eleven class hours per week (90 min. × 11)

Grammar & Vocabulary

This class offers a study of linguistic knowledge which is the basis for all linguistic activity, with emphasis on word usage, vocabulary structure and the mechanism of vocabulary. Expressions intrinsic to the Japanese language, such as idiomatic expressions and idioms, and a wide variety of vocabulary and expressions deeply rooted in the culture as well as the history of Japan will be studied.

Kanji & Vocabulary

This class offers a study of linguistic knowledge which is the basis for all linguistic activity, with emphasis on the origin of kanji and the characteristics of kanji vocabulary. By organizing and re-examining Kanji according to its shape, sound and meaning respectively, a systematic study of kanji vocabulary will be attained .

Academic Reading

Various types of writing such as novels, essays and criticisms will be used, and reading ability will be improved through rapid, intensive, and extensive reading of literature. Furthermore, by carrying out intensive and extensive reading of writings of a particularly special field of study as well as by studying the terminology and expressions of that field, basic technical knowledge required for studying at Japanese universities will be acquired.

Listening Comprehension & Academic Listening

Designed to aurally develop and improve the skill to recognize only the necessary and appropriate items among the various types of information. Furthermore, the student will attend the necessary classes at the university, take memos and notes; thus, based on this, the ability to draw up appropriate answers for exams will be acquired.

Written Presentation

This class is designed to help students to develop basic composition skills for document preparation, with emphasis on the compilation of reports and papers required in Japanese universities. The method of description which most suits the purpose of the document as well as the method of constructing the unique pattern, literary style, vocabulary and theory of the report or paper are examined.

Oral Presentation

This class is designed to help students to develop communication skills, with emphasis on acquiring the basic skills for oral presentation required in Japanese universities. Designed not only to help recognize the manner of expressing one's opinion which best suits each field such as monologues, dialogues, discussions and so on, but also to help acquire the technique necessary when giving research presentations at the university.

3-2. Required Subjects Other Than Japanese Language

Japanese Cultural Background [JC]

One class hour per week (90 min. × 1)

General survey of Japanese culture and a comprehensive introduction to everyday life in Japan. Designed to help students understand both the Japanese way of thinking and various aspects of Japanese society.

Mathematics [MATH]

Two class hours per week (90 min. × 2)

Study of mathematics required for admission to Japanese universities, with emphasis on the mathematical way of thinking and the technical terms and major rhetorical expressions found in this field. Topics include: sets, equations, inequalities, figures, mappings, coordinates, graphs, transformations, radian system, functions, analytic geometry, sequences, series, mathematical induction, binomial theorem and limits.

Chemistry [CHEM]

Two class hours per week (90 min. × 2)

Study of chemistry required for admission to Japanese universities, with emphasis on Japanese chemical terminology, names of elements and chemical compounds, and the technical terms and major rhetorical expressions found in this field. Topics include: the composition of matter, periodicity of chemical properties, chemical reaction calculations, atomic and molecular structure and bonding.

Physics [PHYS]

Two class hours per week (90 min. × 2)

Study of physics required for admission to Japanese universities, with emphasis on the technical terms and major rhetorical expressions found in this field. Topics include: classical dynamics, wave mechanics, electricity, old quantum mechanics, electromagnetics and solid state physics.

Biology [BIOL]

Two class hours per week (90 min. × 2)

Study of biology required for admission to Japanese universities, with emphasis on biological knowledge, Japanese biological terminology and expression. Topics include: the function and structure of cells, reproduction and development, the laws of heredity, biotechnology, biocenosis and ecosystem.

4. Entrance into University

The Ministry of Education, Culture, Sports, Science and Technology (Monbu-kagaku-sho) will decide on the university to which a student should apply for admission in consultation with the university concerned. The student's choice, academic achievement at this Center, the capacity of the university concerned and other factors will be taken into consideration in making this decision.

The student will apply for admission to the university on the basis of the above decision and be admitted to the university after passing the entrance examination required by the university.

Japanese Studies Program [J]

1. Program Outline

The Japanese Studies Program is a one-year program intended for undergraduate-level Monbu-kagaku-sho scholarship recipients specializing in Japanese Studies. In this program, in addition to regular classes, an instructor teaches students individually or in a small group (Directed Research & Reading). The program aims to cultivate individuals who are knowledgeable and active in the fields of Japanese language and culture. Through research and related activities, students acquire a high level of Japanese proficiency, field-specific knowledge, as well as the ability to conduct research and investigations in these areas.

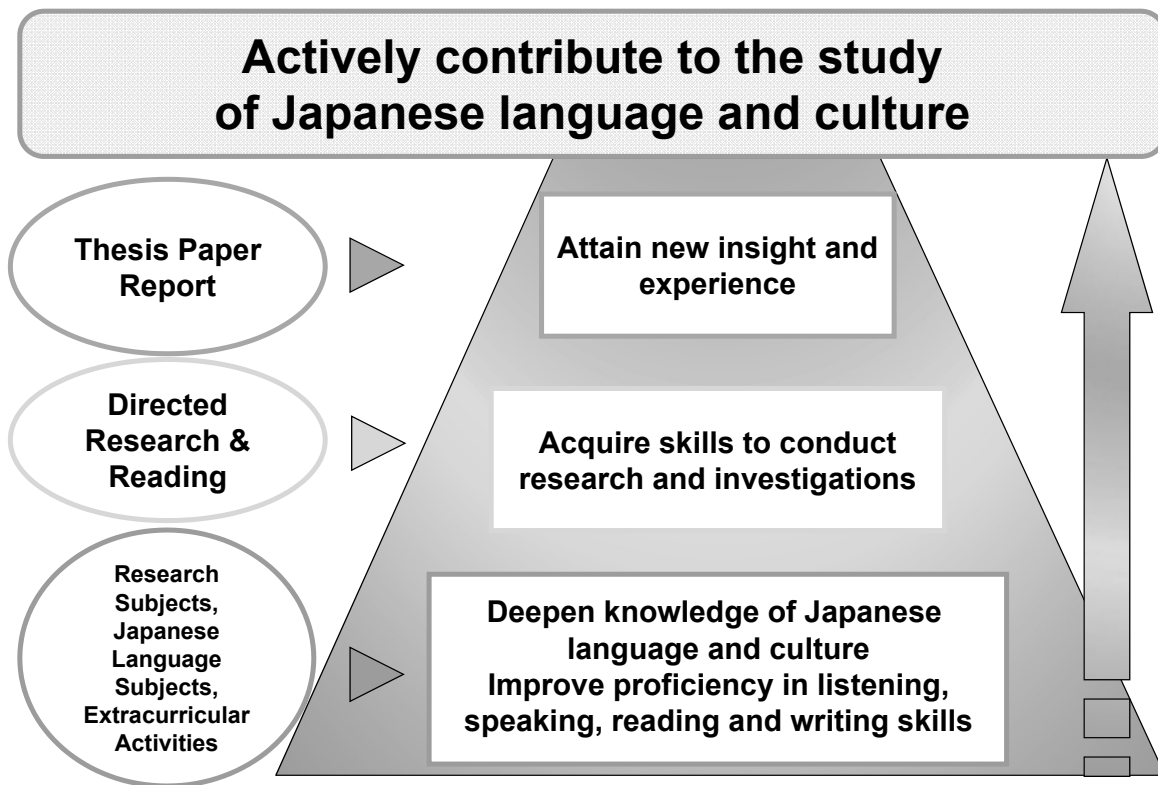

Course Information

The [J] program features a Research Course and a Practical Japanese Course. Students select their course at the beginning of the Fall-Winter term. If a student chooses to change courses, that change is made effective from the following Spring-Summer term. As a general rule, students are not permitted to change courses mid-semester.

Research Course

The Research Course is designed for students interested in research on the Japanese language and culture. In the Research Course students gain research skills by acquiring knowledge and methodology of each research field. Successful students are expected to write a text and make an oral presentation, as well as answer questions using Japanese technical terms. Students submit a paper detailing the results of their research and take an oral exam at the time of completion of the course.

Practical Japanese Course

The Practical Japanese Course is designed for students aspiring to work broadly in society, utilizing their Japanese language skills and knowledge of Japanese culture. In the Practical Japanese Course students gain comprehensive skills through reporting about their activities, engaging in group discussion and participating in course activities both on and off campus. Students also refine the language skills necessary to convey their opinion and understand complex topics. Students are required to write a report on the result of their research and activities at the time of completion of the course.

2. Requirements for [J] Program Certificate

- ① All students must complete the specified number of required subjects and electives in the selected course.
- ② Students must make a midterm presentation and final presentation.
- ③ At the time of completion of the program, Research Course students are required to write and submit a research paper in Japanese and pass an oral interview. Practical Japanese Course students are required to submit a report in Japanese.

Number of required classes for each course

Research Course

Category		Class hours			
		Fall-Winter Terms	Spring-Summer Terms	Subtotal	Total
Required	Directed Research & Reading (JDR)	1	1	2	20 or more
Electives	Japanese Language Subject	at least 6		18 or more	
	Research Subject	at least 6			
Research paper and interview					

Practical Japanese Course

Category		Class hours			
		Fall-Winter Terms	Spring-Summer Terms	Subtotal	Total
Required	Directed Research & Reading (JDR)	1	1	2	23 or more
Electives	Japanese Language Subject	at least 8		21 or more	
	Research Subject	at least 2			
Report					

3. Outline of Subjects

3-1. Required Subjects

Research Course students and Practical Japanese Course students are enrolled in "Directed Research & Reading (JDR)."

【Directed Research & Reading】 (JDR)

An instructor offers careful guidance to students individually or in a small group, taking into consideration each student's interest and their field and purpose of study. Research Course students synthesize their findings and submit a thesis paper. Practical Japanese Course students are guided in the completion of a report on their investigations and experiences conducted on and off campus. All students present their findings at the scheduled presentations.

3-2. Electives

There are two categories of elective class: ①【Japanese Language Subjects】and ②【Research Subjects】.

For detailed information on classes available each semester, please refer to List of Classes.

① **【Japanese Language Subjects】**

Participating students select from a broad range of elective subjects matched to their individual proficiency level. These include Reading (RDG), Listening (LIS), Writing (WRT), Speaking (SPK), Grammar & Vocabulary (GV), and Kanji & Vocabulary (KV) and are offered at the Pre-intermediate, Intermediate, Upper-intermediate and Advanced course levels.

Japanese Pre-intermediate Reading (RDG)

For A2 students who can:

-understand the Japanese alphabet and basic passages in daily situations. For example: in pamphlets, schedules, menus, short e-mails, and private letters.

Japanese Pre-intermediate Listening (LIS)

For A2 students who can:

-comprehend audio in daily situations, such as simple short messages or announcements.

Japanese Pre-intermediate Writing (WRT)

For A2 students who can:

- write short messages or memos on daily matters;
- write brief private e-mails.

Japanese Pre-intermediate Speaking (SPK)

For A2 students who can:

- explain daily matters using elementary words, phrases and sentences;
- conduct brief social exchanges with others.

Japanese Pre-intermediate Grammar & Vocabulary (GV)

For A2 students who can:

- understand basic, commonly-used words within elementary vocabulary;
- understand expressions written in basic sentence patterns.

Japanese Pre-intermediate Kanji & Vocabulary (KV)

For A2 students who can:

- read and write basic kanji commonly-used in daily life;
- understand basic and commonly-used kanji expressions.

Japanese Intermediate Reading (RDG)

For B1 students who can:

- comprehend passages written about daily matters or a topic of their interest, for example, newspaper articles or private letter exchanges.

Japanese Intermediate Listening (LIS)

For B1 students who can:

- comprehend audio about daily matters or a topic of their interest, such as weather forecasts or train station announcements.

Japanese Intermediate Writing (WRT)

For B1 students who can:

- write a short essay about their daily life or a topic of their interest;
- write a short letter or e-mail;
- write a cohesive text using basic words and expressions.

Japanese Intermediate Speaking (SPK)

For B1 students who can:

- make a speech about their daily life or a topic of their interest while using tense correctly;
- express their views using subordinate sentences;
- participate in one-to-one conversation;
- pronounce words without causing misunderstandings.

Japanese Intermediate Grammar & Vocabulary (GV)

For B1 students who can:

- understand most elementary vocabulary;
- understand expressions using basic sentence patterns.

Japanese Intermediate Kanji & Vocabulary (KV)

For B1 students who can:

- read and write basic kanji;
- understand basic kanji expressions.

Japanese Upper-intermediate Reading (RDG)

For B2 students who can:

- understand somewhat technical contents within their field of specialty, including introductory textbooks or lecture materials;
- read modern novels;
- infer the meaning of an unfamiliar word;
- read and understand the stance and opinion of the author.

Japanese Upper-intermediate Listening (LIS)

For B2 students who can:

- understand somewhat technical contents in a long conversation or a lecture within their field of specialty;
- understand news, broadcasts, current events or movies;
- infer the meaning of an unfamiliar word.

Japanese Upper-intermediate Writing (WRT)

For B2 students who can:

- write a report relating to their field of specialty;
- write an article or a report given enough time;
- distinguish fact from their own opinion;
- create paragraphs while considering essay structure;
- write a cohesive text.

Japanese Upper-intermediate Speaking (SPK)

For B2 students who can:

- present a speech about their field of specialty clearly and in detail;
- present their research findings with enough preparation;
- distinguish fact from their own opinion;
- actively engage in a conversation;
- speak fluently to a certain extent.

Japanese Upper-intermediate Grammar & Vocabulary (GV)

For B2 students who can:

- understand fundamental vocabulary relating to their field of specialty;
- understand expressions using somewhat high-level sentence patterns.

Japanese Upper-intermediate Kanji & Vocabulary (KV)

For B2 students who can:

- read and write somewhat high-level commonly-used kanji;
- understand commonly-used kanji expressions in addition to somewhat high-level kanji expressions within their field of specialty.

Japanese Advanced Reading (RDG)

For C1 students who can:

- understand texts from various fields written in standard Japanese;
- understand an introductory book even if it is not of their field of specialty;
- understand a technical book, an article or lecture material of a high level if it is of their field of specialty;
- understand the part of a text emphasized by the author.

Japanese Advanced Listening (LIS)

For C1 students who can:

- understand topics from various fields spoken in standard Japanese;
- understand a basic-level lecture even if it is not of their field of specialty;
- understand a higher-level lecture of their field of specialty;
- enjoy most TV programs or movies without any special effort;
- grasp the flow of a conversation with more than three participants.

Japanese Advanced Writing (WRT)

For C1 students who can:

- write a somewhat technical article or report about subjects from various fields;
- write a cohesive text;
- put an emphasis on their opinion in the text.

Japanese Advanced Speaking (SPK)

For C1 students who can:

- present a speech containing somewhat technical content about subjects from various fields;
- coherently present an argument from a single perspective;
- participate in conversations while cooperating with other participants;
- express themselves fluently.

Japanese Advanced Grammar & Vocabulary (GV)

For C1 students who:

- understand fundamental vocabulary within a variety of fields;
- understand the highest level sentence patterns necessary for any social situation.

Japanese Advanced Kanji & Vocabulary (KV)

For C1 students who:

- read and write almost all kanji used in daily life;
- understand almost all kanji expressions necessary for conducting any social situation;
- understand higher-level kanji expressions if it is of their field of specialty.

② **【Research Subjects】**

These subjects allow students to gain the requisite knowledge and skills to conduct research in their field. Through language and language education, as well as the study of literature, history, sociology and Japanese thought, students acquire a contrastive perspective of Japanese culture and are able to engage in discussion of content learned in class to deepen their understanding.

The following classes are offered: Japanese Linguistics, Japanese Language Education, Japanese Thought, Japanese History, Japanese Literature, Japanese Contemporary Culture, and Japanese Social Sciences.

For each Research Subject, there is an introductory course (“Introduction to XX”) that provides foundational knowledge in the subject concerned while taking into consideration students’ practical ability.

Japanese Linguistics (LIN)

Students analyze various characteristics of the Japanese language from a linguistic perspective. This involves the subfields of phonetics and phonology, morphology and syntax, pragmatics and semantics, typology, contrastive linguistics, social linguistics, and the history of Japanese.

Japanese Language Education (EDU)

This subject provides students with the requisite knowledge and perspective used in examining various aspects of Japanese language education. This includes basic knowledge of Japanese language education, second language acquisition and language pedagogy. Students learn to apply knowledge from related fields such as linguistics and Japanese linguistics in order to deepen their understanding of language education.

Japanese Thought (THO)

This subject examines Japanese thought through disciplines such as religious studies, folkloristics, and cultural anthropology. Students investigate Japanese culture and society from a historical perspective, looking closely at aspects of traditional Japanese culture such as annual festivals and functions.

Japanese History (HIS)

This subject teaches Japanese history spanning from ancient to modern times. Students explore topics in Japanese society and Japanese culture through the lens of Japanese history. This includes cultural history, as well as practices like Japanese calligraphy and tea ceremony.

Japanese Literature (LIT)

This subject teaches Japanese classical literature, dating from the Nara period to the Edo period, as well as modern and contemporary literature, written from the Meiji period onward. This subject deals also with literary history and criticism, as well as traditional Japanese performing arts.

Japanese Contemporary Culture (CON)

This subject teaches contemporary and modern Japanese culture as well as research methodology. Students familiarize themselves with cultural characteristics, historical trends and current problems facing Japanese society. Knowledge of research methods used in sociology and comparative culture deepens students' understanding of cultural research.

Japanese Social Sciences (SOC)

This subject examines Japanese society from a sociological perspective, considering politics, economics and management, including discussion of international relations. Students deepen their understanding of Japanese society through investigations of current affairs and historical analyses.

- ※ Depending on the results of the placement test, those students for whom it is deemed necessary are required to take Japanese Language Subjects (JGV or MGV α/β , etc.) designated by their instructors.
- ※ Depending on the results of the placement test, students who are judged to be within the C2 range of Japanese proficiency must take a specified number of research subjects per year: a minimum of 18 for Research Course students, and a minimum of 21 for Practical Japanese Course students.
- ※ In the Spring-Summer term, students may register and take up to two classes offered by other faculties. These classes relate to Japanese language and culture and are specifically designated by the CJLC. Such classes count as Research subjects (R) toward the credit requirements for completion of the J Program.

4. Extracurricular Activities

To improve students' Japanese language skills and to deepen their understanding of Japanese language, culture and society, the CJLC plans various activities on and off campus.

- (1) The CJLC offers opportunities to view Japanese traditional performing arts, such as *kabuki* and *bunraku*, in order to help students deepen their understanding of Japanese art and culture.
- (2) The CJLC plans tours of places of interest for students to help them better understand Japanese history, folklore, economy and business management.
- (3) To experience the culture of Japanese daily life, students may participate in the host family program and other events organized or introduced by Osaka University Center for International Education and Exchange (first floor of Building B, Minoh Campus).

※ Various activities are organized in addition to those listed above. Detailed information will be posted on the bulletin board near the CJLC Office.

Maple Program [M]

1. Program Outline

The Maple Program (Osaka University Intensive Japanese Language and Culture Program for Exchange Students) is a short-term student exchange program of Osaka University hosted by the Center for Japanese Language and Culture (CJLC). This one-year program consists of two terms: a Fall-Winter term from September to March, and a Spring-Summer term from April to August.

The program is designed to help students improve their Japanese language skills as well as enhance their knowledge of Japanese culture and society, moving them further towards their respective academic goals. Moreover, it aims to cultivate the human resources required to deeply understand Japan from various perspectives by giving students the academic tools to compare and contrast Japanese language, culture and society with their own, and then share that knowledge widely.

A faculty advisor is assigned by the CJLC to each student enrolled in the program to provide advice regarding subject registration and other academic activities.

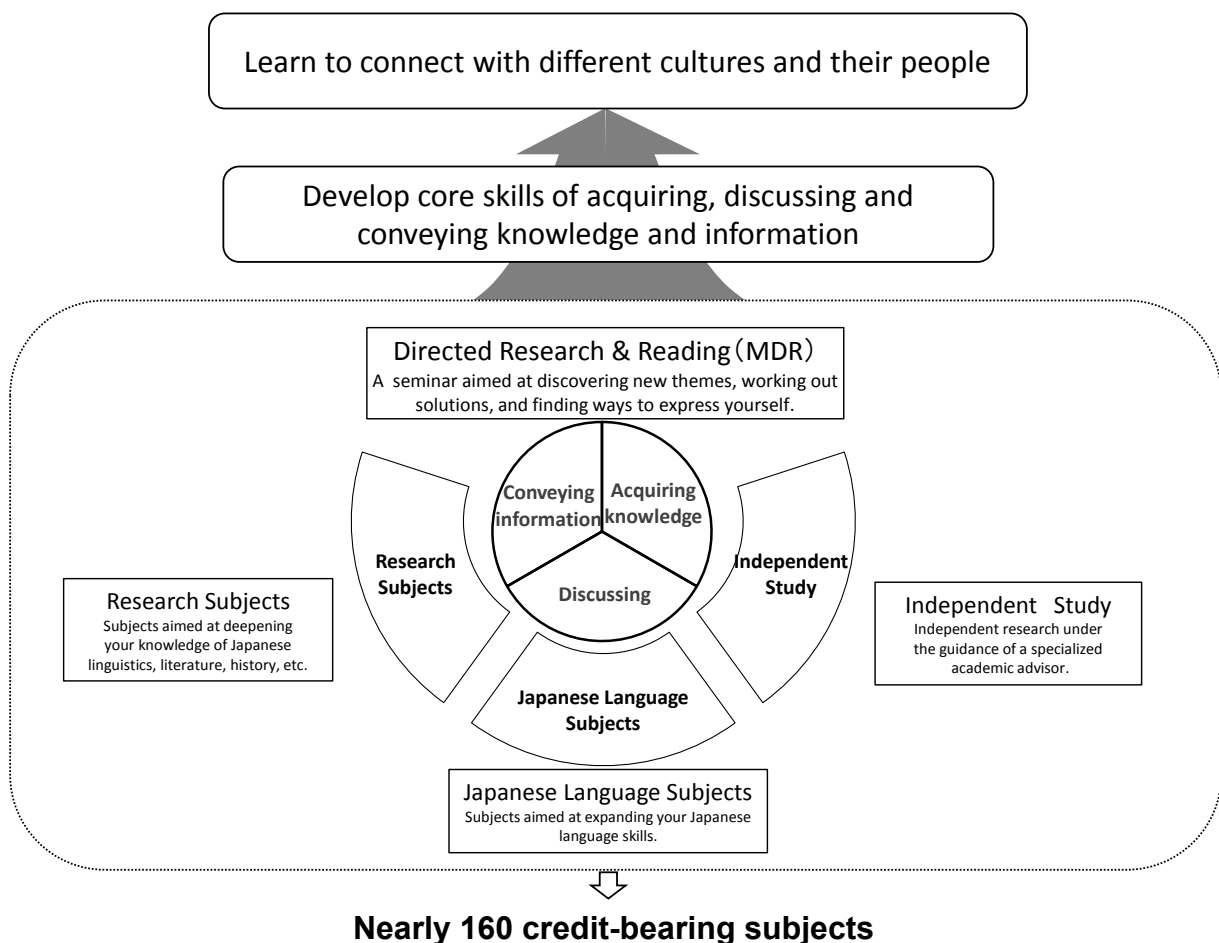

Course information

The Maple Program features four courses: Pre-intermediate, Intermediate, Upper-intermediate and Advanced. Students are placed in one of these four courses based on the results of a preliminary placement test.

Pre-intermediate Course

This course is designed for students evaluated to be within the CJLC's A2 range of Japanese language proficiency. Students learn Japanese language and culture through a range of activities conducted in "Directed Research & Reading" and further refine their grammar and vocabulary through the courses "Pre-intermediate Japanese α : Grammar & Vocabulary" and "Pre-intermediate Japanese β : Grammar & Vocabulary." Students may choose elective classes from both the Pre-intermediate and Intermediate course levels.

Intermediate Course

This course is designed for students evaluated to be within the CJLC's B1 range of Japanese language proficiency. Students learn Japanese language and culture through a range of activities conducted in "Directed Research & Reading" and further refine their grammar and vocabulary through the courses "Intermediate Japanese α : Grammar & Vocabulary" and "Intermediate Japanese β : Grammar & Vocabulary." In addition to classes offered at the Intermediate course level, students may take elective classes from both the Pre-intermediate and Upper-intermediate course levels.

Upper-intermediate Course

The Upper-intermediate Course is intended for students evaluated to be within the CJLC's B2 range of Japanese language proficiency. Students learn Japanese language and culture through a range of activities conducted in "Directed Research & Reading." In addition to classes offered at the Upper-intermediate course level, students may take elective classes from both the Intermediate and Advanced course levels.

Advanced Course

The Advanced Course is designed for students evaluated to be within the CJLC's C1 range of Japanese language proficiency. Students learn Japanese language and culture through a range of activities conducted in "Directed Research & Reading." Advanced Course students may choose elective classes from the Upper-intermediate and Advanced course levels.

2. Requirements for [M] Program Certificate

To complete the program, students must earn 30 or more credits in a year.

Category	Course	Credits	Requirements for completion
Required	Directed Research & Reading (MDR)	2 credits each	30 or more credits in a year
Electives	Research Subjects		
	Independent Study (MIS)		
Required (Pre-intermediate Japanese Course)	Pre-intermediate Japanese α : Grammar & Vocabulary (MGV α)	4 credits	
	Pre-intermediate Japanese β : Grammar & Vocabulary (MGV β)	2 credits	
Required (Intermediate Japanese Course)	Intermediate Japanese α : Grammar & Vocabulary (MGV α)	4 credits	
	Intermediate Japanese β : Grammar & Vocabulary (MGV β)	2 credits	
Electives	Japanese Language Subjects	1 credit each	

※ With their academic advisor's permission, students may substitute an elective course for Pre-intermediate Japanese α/β : Grammar & Vocabulary and Intermediate Japanese α/β : Grammar & Vocabulary.

3. Outline of Subjects

The Maple Program offers the following subjects: Directed Research & Reading (MDR), Japanese Language Subjects (L), Pre-Intermediate Japanese α/β : Grammar & Vocabulary (MGV), Intermediate Japanese α/β : Grammar & Vocabulary (MGV), Research Subjects in Japanese Studies (R), and Independent Study (MIS).

3-1. Required Subjects

All Maple Program students are required to take “Directed Research & Reading.” Students in the Pre- intermediate Course or Intermediate Course are additionally required to take “Pre-intermediate Japanese: Grammar & Vocabulary(α/β)” or “Intermediate Japanese: Grammar & Vocabulary (α/β).”

① **【Directed Research & Reading】 (MDR)**

This seminar stimulates comprehensive understanding of Japanese language and culture. Students experience Japanese culture and society first-hand by going on field trips and deepen their intercultural understanding through the guidance of Japanese tutors and teaching assistants, thus approaching this seminar's ultimate goal: a comprehensive understanding of Japanese language, culture and society. To ensure effective and smooth communication, we will focus on the development of students' ability to gain knowledge, as well as to discuss and to convey information. This is a compulsory seminar.

② **【Pre-intermediate Japanese α/β : Grammar & Vocabulary】 (MGV)**

These courses are for students evaluated to be within the CJLC's A2 range of Japanese language proficiency. The goal of these courses is to improve students' knowledge of grammar and vocabulary as well as increase their range of practical fluency. Based on the results of a placement examination, students will be required to take either both Pre-intermediate Japanese α (4 units per week) and Pre-intermediate Japanese β (2 units per week), or Pre-intermediate Japanese α alone.

② **【Intermediate Japanese α/β : Grammar & Vocabulary】 (MGV)**

These courses are for students evaluated to be within the CJLC's B1 range of Japanese language proficiency. The goal of these courses is to improve students' knowledge of grammar and vocabulary as well as increase their range of practical fluency. Based on the results of a placement examination, students will be required to take either both Intermediate Japanese α (4 units per week) and Intermediate Japanese β (2 units per week), or Intermediate Japanese α alone.

3-2. Electives

There are three categories of elective class: ① **【Japanese Language Subjects】**, ② **【Research Subjects】**, and ③ **【Independent Study】**.

For detailed information on classes available each semester, please refer to List of Classes.

① **【Japanese Language Subjects】**

Participating students select from a broad range of elective subjects matched to their individual proficiency level. These include Reading (RDG), Listening (LIS), Writing (WRT), Speaking (SPK), Grammar & Vocabulary (GV), and Kanji & Vocabulary (KV) and are offered at the Pre-intermediate, Intermediate, Upper-intermediate and Advanced course levels.

Japanese Pre-intermediate Reading (RDG)

For A2 students who can:

- understand the Japanese alphabet and basic passages in daily situations. For example: in pamphlets, schedules, menus, short e-mails, and private letters.

Japanese Pre-intermediate Listening (LIS)

For A2 students who can:

- comprehend audio in daily situations, such as simple short messages or announcements.

Japanese Pre-intermediate Writing (WRT)

For A2 students who can:

- write short messages or memos on daily matters;
- write brief private e-mails.

Japanese Pre-intermediate Speaking (SPK)

For A2 students who can:

- explain daily matters using elementary words, phrases and sentences;
- conduct brief social exchanges with others.

Japanese Pre-intermediate Grammar & Vocabulary (GV)

For A2 students who can:

- understand basic, commonly-used words within elementary vocabulary;
- understand expressions written in basic sentence patterns.

Japanese Pre-intermediate Kanji & Vocabulary (KV)

For A2 students who can:

- read and write basic kanji commonly-used in daily life;
- understand basic and commonly-used kanji expressions.

Japanese Intermediate Reading (RDG)

For B1 students who can:

- comprehend passages written about daily matters or a topic of their interest, for example, newspaper articles or private letter exchanges.

Japanese Intermediate Listening (LIS)

For B1 students who can:

- comprehend audio about daily matters or a topic of their interest, such as weather forecasts or train station announcements.

Japanese Intermediate Writing (WRT)

For B1 students who can:

- write a short essay about their daily life or a topic of their interest;
- write a short letter or e-mail;
- write a cohesive text using basic words and expressions.

Japanese Intermediate Speaking (SPK)

For B1 students who can:

- make a speech about their daily life or a topic of their interest while using tense correctly;
- express their views using subordinate sentences;
- participate in one-to-one conversation;
- pronounce words without causing misunderstandings.

Japanese Intermediate Grammar & Vocabulary (GV)

For B1 students who can:

- understand most elementary vocabulary;
- understand expressions using basic sentence patterns.

Japanese Intermediate Kanji & Vocabulary (KV)

For B1 students who can:

- read and write basic kanji;
- understand basic kanji expressions.

Japanese Upper-intermediate Reading (RDG)

For B2 students who can:

- understand somewhat technical contents within their field of specialty, including introductory textbooks or lecture materials;
- read modern novels;
- infer the meaning of an unfamiliar word;
- read and understand the stance and opinion of the author.

Japanese Upper-intermediate Listening (LIS)

For B2 students who can:

- understand somewhat technical contents in a long conversation or a lecture within their field of specialty;
- understand news, broadcasts, current events or movies;
- infer the meaning of an unfamiliar word.

Japanese Upper-intermediate Writing (WRT)

For B2 students who can:

- write a report relating to their field of specialty;
- write an article or a report given enough time;
- distinguish fact from their own opinion;
- create paragraphs while considering essay structure;
- write a cohesive text.

Japanese Upper-intermediate Speaking (SPK)

For B2 students who can:

- present a speech about their field of specialty clearly and in detail;
- present their research findings with enough preparation;
- distinguish fact from their own opinion;
- actively engage in a conversation;
- speak fluently to a certain extent.

Japanese Upper-intermediate Grammar & Vocabulary (GV)

For B2 students who can:

- understand fundamental vocabulary relating to their field of specialty;
- understand expressions using somewhat high-level sentence patterns.

Japanese Upper-intermediate Kanji & Vocabulary (KV)

For B2 students who can:

- read and write somewhat high-level commonly-used kanji;
- understand commonly-used kanji expressions in addition to somewhat high-level kanji expressions within their field of specialty.

Japanese Advanced Reading (RDG)

For C1 students who can:

- understand texts from various fields written in standard Japanese;
- understand an introductory book even if it is not of their field of specialty;
- understand a technical book, an article or lecture material of a high level if it is of their field of specialty;
- understand the part of a text emphasized by the author.

Japanese Advanced Listening (LIS)

For C1 students who can:

- understand topics from various fields spoken in standard Japanese;
- understand a basic-level lecture even if it is not of their field of specialty;
- understand a higher-level lecture of their field of specialty;
- enjoy most TV programs or movies without any special effort;
- grasp the flow of a conversation with more than three participants.

Japanese Advanced Writing (WRT)

For C1 students who can:

- write a somewhat technical article or report about subjects from various fields;
- write a cohesive text;
- put an emphasis on their opinion in the text.

Japanese Advanced Speaking (SPK)

For C1 students who can:

- present a speech containing somewhat technical content about subjects from various fields;
- coherently present an argument from a single perspective;
- participate in conversations while cooperating with other participants;
- express themselves fluently.

Japanese Advanced Grammar & Vocabulary (GV)

For C1 students who:

- understand fundamental vocabulary within a variety of fields;
- understand the highest level sentence patterns necessary for any social situation.

Japanese Advanced Kanji & Vocabulary (KV)

For C1 students who:

- read and write almost all kanji used in daily life;
- understand almost all kanji expressions necessary for conducting any social situation;
- understand higher-level kanji expressions if it is of their field of specialty.

② **【Research Subjects】**

These subjects offer students the opportunity to pursue academic knowledge in their field. Through language and language education, as well as the study of literature, history, sociology and Japanese thought, students acquire a contrastive perspective of Japanese culture and discuss content learned in class. Classes are conducted in Japanese, with some classes conducted in English.

The following classes are offered: Japanese Linguistics, Japanese Language Education, Japanese Thought, Japanese History, Japanese Literature, Japanese Contemporary Culture, and Japanese Social Sciences.

For each Research Subject, there is an introductory course (“Introduction to XX”) that provides foundational knowledge in the subject concerned while taking into consideration students’ practical ability.

Japanese Linguistics (LIN)

Students analyze various characteristics of the Japanese language from a linguistic perspective. This involves the subfields of phonetics and phonology, morphology and syntax, pragmatics and semantics, typology, contrastive linguistics, social linguistics, and the history of Japanese.

Japanese Language Education (EDU)

This subject provides students with the requisite knowledge and perspective used in examining various aspects of Japanese language education. This includes basic knowledge of Japanese language education, second language acquisition and language pedagogy. Students learn to apply knowledge from related fields such as linguistics and Japanese linguistics in order to deepen their understanding of language education.

Japanese Thought (THO)

This subject examines Japanese thought through disciplines such as religious studies, folkloristics, and cultural anthropology. Students investigate Japanese culture and society from a historical perspective, looking closely at aspects of traditional Japanese culture such as annual festivals and functions.

Japanese History (HIS)

This subject teaches Japanese history spanning from ancient to modern times. Students explore topics in Japanese society and Japanese culture through the lens of Japanese history. This includes cultural history, as well as practices like Japanese calligraphy and tea ceremony.

Japanese Literature (LIT)

This subject teaches Japanese classical literature, dating from the Nara period to the Edo period, as well as modern and contemporary literature, written from the Meiji period onward. This subject deals also with literary history and criticism, as well as traditional Japanese performing arts.

Japanese Contemporary Culture (CON)

This subject teaches contemporary and modern Japanese culture as well as research methodology. Students familiarize themselves with cultural characteristics, historical trends and current problems facing Japanese society. Knowledge of research methods used in sociology and comparative culture deepens students' understanding of cultural research.

Japanese Social Sciences (SOC)

This subject examines Japanese society from a sociological perspective, considering politics, economics and management, including discussion of international relations. Students deepen their understanding of Japanese society through investigations of current affairs and historical analyses.

③ 【Independent Study】 (MIS)

In Independent Study, students read and interpret primary sources they have gathered in Japan and conduct investigative research. Students acquire deeper knowledge of Japanese language and culture through self-directed data collection and analysis, under the guidance and instruction of a supervisor. In order to enroll in the course, students must pass a review based on document submission and an interview exam.

4. Extracurricular Activities

To improve students' Japanese language skills and to deepen their understanding of Japanese language, culture and society, the CJLC plans various activities on and off campus.

- (1) As part of Directed Research and Reading, educational field trips are scheduled for locations in the vicinity. These trips are intended to provide students with an immersive experience of Japanese society and culture.
- (2) The CJLC plans tours of places of interest for students to help them better understand Japanese history, folklore, economy and business management.
- (3) The CJLC also offers opportunities to view Japanese traditional performing arts, such as *kabuki* and *bunraku*, in order to help students deepen their understanding of Japanese art and culture.
- (4) To experience the culture of Japanese daily life, students may participate in the host family program and other events organized or introduced by Osaka University Center for International Education and Exchange (first floor of Building B, Minoh Campus).

※ Various activities are organized in addition to those listed above. Detailed information will be posted on the bulletin board near the CJLC Office.

OU Foundation Program [F]

1. Program Outline

OU Foundation Program is a half-year preparatory program for the students who are admitted by Special Entrance Examination for Privately-Funded Undergraduate International Students Living Overseas. The program is designed to help students develop the knowledge and advanced skills in the Japanese language required for academic activities in universities.

Students are classified into the Humanities/Social Sciences and Natural Sciences Courses, according to their fields of study. They are required to successfully complete the subjects of the program.

Course information

Humanities/Social Sciences Major Course [F (H/SS)]

This course is intended for students majoring in Humanities/Social Sciences. The Modern Japanese classes consist of advanced and academic Japanese subjects. In this course, students are required to enroll in not only Japanese Language subjects and Japanese Cultural Background, but also Politics & Economics and Japanese History courses.

Natural Sciences Major Course [F (NS)]

This course is intended for students majoring in natural sciences. The Modern Japanese classes are offered from the beginner's class to the upper grade. Mathematics is a required subject. In this course, advanced level students are required to enroll in not only Japanese Language subjects and Mathematics, but also, Physics, Chemistry, Biology and Japanese Cultural Background courses.

2. Requirements for [F] Program Certificate

- ① All the required and the required electives subjects must be completed.
- ② The minimum rate of attendance for all the required subjects and electives is 80%.
- ③ All the students majoring in economics and business administration must take the mathematics elective offered for the Humanities/Social Sciences Major Course.
- ④ Final examination is held for all subjects and must be taken during the scheduled examination term from January through February. For the examination term, see the Academic Calendar.
- ⑤ All the results of the examination are reported to the department you will enroll in. The marks of the scheduled examination must not be lower than 60%.

Humanities/Social Sciences Major Course [F (H/SS)]

① Upper-intermediate ~ Advanced Level

Category	Course		Class hours	
Required Electives	Japanese Language Subjects	Japanese Upper-intermediate/Advanced Reading (RDG) Japanese Upper-intermediate/Advanced Listening (LIS) Japanese Upper-intermediate/Advanced Writing (WRT) Japanese Upper-intermediate/Advanced Speaking (SPK) Japanese Upper-intermediate/Advanced Grammar & Vocabulary(GV) Japanese Upper-intermediate /Advanced Kanji & Vocabulary (KV)	10	11
Required	Seminar	Modern Japanese (FJPN)	1	
		Japanese Cultural Background (JC)	1	
		Politics & Economics (POLI)	2	
		Japanese History (HIST)	2	
Electives		Mathematics for H/SS Course (MATH)	2	

Natural Sciences Major Course [F (NS)]

① Upper-intermediate ~ Advanced Level

Category	Course		Class hours	
Required Electives	Japanese Language Subjects	Japanese Upper-intermediate/Advanced Reading (RDG) Japanese Upper-intermediate/Advanced Listening (LIS) Japanese Upper-intermediate/Advanced Writing (WRT) Japanese Upper-intermediate/Advanced Speaking (SPK) Japanese Upper-intermediate/Advanced Grammar & Vocabulary (GV) Japanese Upper-intermediate /Advanced Kanji & Vocabulary (KV)	10	11
		Seminar	Modern Japanese (FJPN)	
Required	Japanese Cultural Background (JC)		1	
	Mathematics for NS Course (MATH)		2	
	Chemistry (CHEM)		2	
Electives	Physics (PHYS)		2	
	Biology (BIOL)		2	

② Pre-intermediate ~ Upper-intermediate Level

Category	Course		Class hours	
Required	Japanese Language Subjects	Modern Japanese (FJPN)	10	11
	Seminar	Modern Japanese (FJPN)	1	
	Mathematics for NS Course (MATH)		2	
Required Electives	Japanese Language Subjects	Japanese Pre-intermediate/Intermediate/Upper-Intermediate Reading (RDG) Japanese Pre-intermediate/Intermediate/Upper-Intermediate Listening (LIS) Japanese Pre-intermediate/Intermediate/Upper-Intermediate Writing (WRT) Japanese Pre-intermediate/Intermediate/Upper-Intermediate Speaking (SPK) Japanese Pre-intermediate/Intermediate/Upper-Intermediate Grammar & Vocabulary (GV) Japanese Pre-intermediate/Intermediate/Upper-Intermediate Kanji & Vocabulary (KV)	5	

③ Elementary Level

Category	Course		Class hours	
Required	Japanese Language Subjects	Modern Japanese (FJPN)	15	16
	Seminar	Modern Japanese (FJPN)	1	
	Mathematics for NS Course (MATH)		2	

3. Outline of Subjects

3-1. Japanese Language Subjects

Modern Japanese: Advanced Japanese [FJPN]

Fundamentals of modern Japanese, including grammar (about 200 sentence patterns), vocabulary (about 4,000 words), present-day Japanese writing system and essential Kanji (about 600 Chinese characters), with emphasis on four basic language skills: reading and listening comprehension, speaking, and writing. Small tests of the vocabulary, rhetorical expressions, and Kanji covered in class will be given at the end of every lesson.

Modern Japanese: Intermediate Japanese [FJPN]

Designed to develop sophisticated skills in modern Japanese through practice and analysis of about 250 basic sentence patterns and 5,000 essential words, with emphasis on reading comprehension and writing. Small tests of the vocabulary, rhetorical expressions, and Kanji covered in class will be given at the end of every lesson.

Japanese Language Subjects (RDG, LIS, WRT, SPK, GV, KV)

Participating students select from a broad range of elective subjects matched to their individual proficiency level. These include Reading (RDG), Listening (LIS), Writing (WRT), Speaking (SPK), Grammar & Vocabulary (GV), and Kanji & Vocabulary (KV) and are offered at the Pre-intermediate, Intermediate, Upper-intermediate and Advanced course levels.

Japanese Pre-intermediate Reading (RDG)

For A2 students who can:

- understand the Japanese alphabet and basic passages in daily situations. For example: in pamphlets, schedules, menus, short e-mails, and private letters.

Japanese Pre-intermediate Listening (LIS)

For A2 students who can:

- comprehend audio in daily situations, such as simple short messages or announcements.

Japanese Pre-intermediate Writing (WRT)

For A2 students who can:

- write short messages or memos on daily matters;
- write brief private e-mails.

Japanese Pre-intermediate Speaking (SPK)

For A2 students who can:

- explain daily matters using elementary words, phrases and sentences;
- conduct brief social exchanges with others.

Japanese Pre-intermediate Grammar & Vocabulary (GV)

For A2 students who can:

- understand basic, commonly-used words within elementary vocabulary;
- understand expressions written in basic sentence patterns.

Japanese Pre-intermediate Kanji & Vocabulary (KV)

For A2 students who can:

- read and write basic kanji commonly-used in daily life;
- understand basic and commonly-used kanji expressions.

Japanese Intermediate Reading (RDG)

For B1 students who can:

- comprehend passages written about daily matters or a topic of their interest, for example, newspaper articles or private letter exchanges.

Japanese Intermediate Listening (LIS)

For B1 students who can:

- comprehend audio about daily matters or a topic of their interest, such as weather forecasts or train station announcements.

Japanese Intermediate Writing (WRT)

For B1 students who can:

- write a short essay about their daily life or a topic of their interest;
- write a short letter or e-mail;
- write a cohesive text using basic words and expressions.

Japanese Intermediate Speaking (SPK)

For B1 students who can:

- make a speech about their daily life or a topic of their interest while using tense correctly;
- express their views using subordinate sentences;
- participate in one-to-one conversation;
- pronounce words without causing misunderstandings.

Japanese Intermediate Grammar & Vocabulary (GV)

For B1 students who can:

- understand most elementary vocabulary;
- understand expressions using basic sentence patterns.

Japanese Intermediate Kanji & Vocabulary (KV)

For B1 students who can:

- read and write basic kanji;
- understand basic kanji expressions.

Japanese Upper-intermediate Reading (RDG)

For B2 students who can:

- understand somewhat technical contents within their field of specialty, including introductory textbooks or lecture materials;
- read modern novels;
- infer the meaning of an unfamiliar word;
- read and understand the stance and opinion of the author.

Japanese Upper-intermediate Listening (LIS)

For B2 students who can:

- understand somewhat technical contents in a long conversation or a lecture within their field of specialty;
- understand news, broadcasts, current events or movies;
- infer the meaning of an unfamiliar word.

Japanese Upper-intermediate Writing (WRT)

For B2 students who can:

- write a report relating to their field of specialty;
- write an article or a report given enough time;
- distinguish fact from their own opinion;
- create paragraphs while considering essay structure;
- write a cohesive text.

Japanese Upper-intermediate Speaking (SPK)

For B2 students who can:

- present a speech about their field of specialty clearly and in detail;
- present their research findings with enough preparation;
- distinguish fact from their own opinion;
- actively engage in a conversation;
- speak fluently to a certain extent.

Japanese Upper-intermediate Grammar & Vocabulary (GV)

For B2 students who can:

- understand fundamental vocabulary relating to their field of specialty;
- understand expressions using somewhat high-level sentence patterns.

Japanese Upper-intermediate Grammar & Kanji (KV)

For B2 students who can:

- read and write somewhat high-level commonly-used kanji;
- understand commonly-used kanji expressions in addition to somewhat high-level kanji expressions within their field of specialty.

Japanese Advanced Reading (RDG)

For C1 students who can:

- understand texts from various fields written in standard Japanese;
- understand an introductory book even if it is not of their field of specialty;
- understand a technical book, an article or lecture material of a high level if it is of their field of specialty;
- understand the part of a text emphasized by the author.

Japanese Advanced Listening (LIS)

For C1 students who can:

- understand topics from various fields spoken in standard Japanese;
- understand a basic-level lecture even if it is not of their field of specialty;
- understand a higher-level lecture of their field of specialty;
- enjoy most TV programs or movies without any special effort;
- grasp the flow of a conversation with more than three participants.

Japanese Advanced Writing (WRT)

For C1 students who can:

- write a somewhat technical article or report about subjects from various fields;
- write a cohesive text;
- put an emphasis on their opinion in the text.

Japanese Advanced Speaking (SPK)

For C1 students who can:

- present a speech containing somewhat technical content about subjects from various fields;
- coherently present an argument from a single perspective;
- participate in conversations while cooperating with other participants;
- express themselves fluently.

Japanese Advanced Grammar & Vocabulary (GV)

For C1 students who:

- understand fundamental vocabulary within a variety of fields;
- understand the highest level sentence patterns necessary for any social situation.

Japanese Advanced Kanji & Vocabulary (KV)

For C1 students who:

- read and write almost all kanji used in daily life;
- understand almost all kanji expressions necessary for conducting any social situation;
- understand higher-level kanji expressions if it is of their field of specialty.

3-2. Subjects Other Than Japanese Language

Japanese Cultural Background [JC]

One class hour per week (90 min. × 1)

General survey of Japanese culture and a comprehensive introduction to everyday life in Japan. Designed to help students understand both the Japanese way of thinking and various aspects of Japanese society.

Politics and Economics (for H/SS students) [POLI]

Two class hours per week (90 min. × 2)

Study of politics and economics required for admission to Japanese universities. General survey of the Japanese economy and Japanese government politics, with emphasis on study of the technical terms and major rhetorical expressions found in this field. Topics include Japanese political system, the Constitution of Japan, Japanese economy and relative microeconomics and macroeconomics, and some environmental problems. This class is designed to nurture the understanding of textbooks on politics and economics, and furthermore the ability to read literature, understand lectures as well as the ability to have discussions in Japanese through the comprehension of technical terms in Japanese.

Japanese History (for H/SS students) [HIST]

Two class hours per week (90 min. × 2)

Study of history required for admission to Japanese universities. General survey of Japanese history from prehistoric to present time, with emphasis on study of the technical terms and major rhetorical expressions found in this field. With focus on the events and issues from the Azuchi-Momoyama era to modern times, topics include creation of a unified state, Japan's modernization and contemporary issues.

Mathematics (for H/SS students) [MATH]

Two class hours per week (90 min. × 2)

Elective Mathematics for students who will enroll in School of Economics and School of Human Sciences.

Study of mathematics required for admission to Japanese universities with emphasis is on studying the fundamental terms and major rhetorical expressions found in this field. Topics include: algebra, linear and quadratic equations, combinatorics, probability, differential calculus, integral calculus and analytic geometry.

Mathematics (for NS students) [MATH]

Two class hours per week (90 min. × 2)

Study of mathematics required for admission to Japanese universities, with emphasis on the mathematical way of thinking and the technical terms and major rhetorical expressions found in this field.

Topics include: sets, equations, inequalities, figures, mappings, coordinates, graphs, transformations, radian system, functions, analytic geometry, sequences, series, mathematical induction, binomial theorem and limits.

Chemistry (for NS students) [CHEM]

Two class hours per week (90 min. × 2)

Study of chemistry required for admission to Japanese universities, with emphasis on Japanese chemical terminology, names of elements and chemical compounds, and the technical terms and major rhetorical expressions found in this field.

Topics include: the composition of matter, periodicity of chemical properties, chemical reaction calculations, atomic and molecular structure and bonding.

Physics (for NS students) [PHYS]

Two class hours per week (90 min. × 2)

Study of physics required for admission to Japanese universities, with emphasis on the technical terms and major rhetorical expressions found in this field.

Topics include: classical dynamics, wave mechanics, electricity, old quantum mechanics, electromagnetics and solid state physics.

Biology (for NS students) [BIOL]

Two class hours per week (90 min. × 2)

Study of biology required for admission to Japanese universities, with emphasis on biological knowledge, Japanese biological terminology and expression. Topics include: the function and structure of cells, reproduction and development, the laws of heredity, biotechnology, biocenosis and ecosystem.

じゅ ぎょう いち らん
授 業 一 覧

List of Classes

※授業じゅぎょうの詳しい内容くわは KOANないようを見てください。
See KOAN for details of each subject.

M Code	J Code	Category	Day・Period	Program	Level	Type	種別	授業科目名	Instructor(s)	教員	
J/M/F (A2) Japanese Language Subjects 日本語実習科目											
1	395010	39J100	RDG	Mon. 3	J/M/F	A2	Rec.	実習	日本語初中級読解(秋冬)	MIHARA. C	三原千佳
2	395015	39J200	LIS	Wed. 4	J/M/F	A2	Rec.	実習	日本語初中級聴解(秋冬)	IMADA	今田恵美
3	395020	39J300	WRT	Thu. 4	J/M/F	A2	Rec.	実習	日本語初中級文章表現(秋冬)	ATSUTA	熱田万美
4	395025	39J400	SPK	Thu. 3	J/M/F	A2	Rec.	実習	日本語初中級口頭表現(秋冬)	MITO	三登由利子
5	395055	39J500	GV	Wed. 3	J/M/F	A2	Rec.	実習	日本語初中級文法・語彙(秋冬)	IDE	井手恭子
6	395030	39J600	KV	Fri. 3	J/M/F	A2	Rec.	実習	日本語初中級漢字・語彙(秋冬)	HIGUCHI	樋口尊子
J/M/F (B1) Japanese Language Subjects 日本語実習科目											
7	395035	39J102	RDG	Mon. 1	J/M/F	B1	Rec.	実習	日本語中級読解(秋冬)	KANAI	金居明生
8	395036	39J104	RDG	Thu. 4	J/M/F	B1	Rec.	実習	日本語中級読解(秋冬)	NONAKA	野中篤
9	395040	39J202	LIS	Mon. 3	J/M/F	B1	Rec.	実習	日本語中級聴解(秋冬)	NISHIMURA	西村多恵
10	395041	39J204	LIS	Thu. 5	J/M/F	B1	Rec.	実習	日本語中級聴解(秋冬)	TAKATSUKI	高月喜美
11	395045	39J302	WRT	Tue. 1	J/M/F	B1	Rec.	実習	日本語中級文章表現(秋冬)	LEE	李裕旋
12	395046	39J304	WRT	Thu. 3	J/M/F	B1	Rec.	実習	日本語中級文章表現(秋冬)	NAMBA	南場尚子
13	395050	39J402	SPK	Mon. 4	J/M/F	B1	Rec.	実習	日本語中級口頭表現(秋冬)	BABA	馬場裕子
14	395051	39J404	SPK	Wed. 3	J/M/F	B1	Rec.	実習	日本語中級口頭表現(秋冬)	SANADA	真田聡美
15	395056	39J502	GV	Wed. 2	J/M/F	B1	Rec.	実習	日本語中級文法・語彙(秋冬)	TANAKA. M	田中舞
16	395057	39J504	GV	Fri. 3	J/M/F	B1	Rec.	実習	日本語中級文法・語彙(秋冬)	MATSUOKA	松岡里奈
17	395060	39J602	KV	Wed. 4	J/M/F	B1	Rec.	実習	日本語中級漢字・語彙(秋冬)	HIROKAWA	廣川直幸
18	395061	39J604	KV	Fri. 1	J/M/F	B1	Rec.	実習	日本語中級漢字・語彙(秋冬)	NAKAJIMA	中嶋伸子
J/M/F (B2) Japanese Language Subjects 日本語実習科目											
19	395065	39J122	RDG	Mon. 2	J/M/F	B2	Rec.	実習	日本語中上級読解(秋冬)	MATSUSHIMA	松島弘枝
20	395066	39J124	RDG	Tue. 1	J/M/F	B2	Rec.	実習	日本語中上級読解(秋冬)	HAYASHI. Y	林由華
21	395067	39J126	RDG	Wed. 1	J/M/F	B2	Rec.	実習	日本語中上級読解(秋冬)	KUBOTA	久保田ゆかり
22	395068	39J128	RDG	Thu. 2	J/M/F	B2	Rec.	実習	日本語中上級読解(秋冬)	FEENER	フィーナー万裕子
23	395069	39J130	RDG	Thu. 3	J/M/F	B2	Rec.	実習	日本語中上級読解(秋冬)	MASHITA	真下恭子
24	395071	39J222	LIS	Mon. 1	J/M/F	B2	Rec.	実習	日本語中上級聴解(秋冬)	KAWABUCHI	川淵節子
25	395072	39J224	LIS	Wed. 2	J/M/F	B2	Rec.	実習	日本語中上級聴解(秋冬)	MINOKAWA	蓑川恵理子
26	395073	39J226	LIS	Wed. 5	J/M/F	B2	Rec.	実習	日本語中上級聴解(秋冬)	KAWASHIMA	川島信恵
27	395074	39J228	LIS	Thu. 2	J/M/F	B2	Rec.	実習	日本語中上級聴解(秋冬)	TANAKA. S	田中里美
28	395075	39J230	LIS	Thu. 5	J/M/F	B2	Rec.	実習	日本語中上級聴解(秋冬)	ATSUTA	熱田万美
29	395076	39J232	LIS	Fri. 3	J/M/F	B2	Rec.	実習	日本語中上級聴解(秋冬)	ATARASHI	新聖子
30	395375	39J322	WRT	Mon. 2	J/M/F	B2	Rec.	実習	日本語中上級文章表現(秋冬)	SAKATA	坂田達紀
31	395376	39J324	WRT	Mon. 3	J/M/F	B2	Rec.	実習	日本語中上級文章表現(秋冬)	MATSUSHIMA	松島弘枝
32	395377	39J326	WRT	Tue. 2	J/M/F	B2	Rec.	実習	日本語中上級文章表現(秋冬)	HAYASHI. Y	林由華
33	395378	39J328	WRT	Wed. 4	J/M/F	B2	Rec.	実習	日本語中上級文章表現(秋冬)	KOMORI	小森万里
34	395379	39J330	WRT	Thu. 4	J/M/F	B2	Rec.	実習	日本語中上級文章表現(秋冬)	OSAKI	大崎紀子
35	395380	39J332	WRT	Fri. 2	J/M/F	B2	Rec.	実習	日本語中上級文章表現(秋冬)	SUZUKI. Y	鈴木由香里
36	395080	39J422	SPK	Mon. 1	J/M/F	B2	Rec.	実習	日本語中上級口頭表現(秋冬)	TANAKA. Y	田中泰子
37	395081	39J424	SPK	Mon. 5	J/M/F	B2	Rec.	実習	日本語中上級口頭表現(秋冬)	IWADE	岩出雪乃
38	395082	39J426	SPK	Wed. 1	J/M/F	B2	Rec.	実習	日本語中上級口頭表現(秋冬)	OOUE	大上協子
39	395083	39J428	SPK	Thu. 1	J/M/F	B2	Rec.	実習	日本語中上級口頭表現(秋冬)	FEENER	フィーナー万裕子
40	395084	39J430	SPK	Thu. 5	J/M/F	B2	Rec.	実習	日本語中上級口頭表現(秋冬)	KONDO	近藤正憲
41	395085	39J432	SPK	Fri. 4	J/M/F	B2	Rec.	実習	日本語中上級口頭表現(秋冬)	ATARASHI	新聖子
42	395385	39J522	GV	Mon. 3	J/M/F	B2	Rec.	実習	日本語中上級文法・語彙(秋冬)	ISHIBASHI	石橋玲央
43	395386	39J524	GV	Tue. 1	J/M/F	B2	Rec.	実習	日本語中上級文法・語彙(秋冬)	HARADA	原田佳代子
44	395387	39J526	GV	Wed. 2	J/M/F	B2	Rec.	実習	日本語中上級文法・語彙(秋冬)	IDE	井手恭子
45	395388	39J528	GV	Thu. 1	J/M/F	B2	Rec.	実習	日本語中上級文法・語彙(秋冬)	FUJII. C	藤井千枝
46	395389	39J530	GV	Thu. 3	J/M/F	B2	Rec.	実習	日本語中上級文法・語彙(秋冬)	KOZAKURA	小桜真未
47	395390	39J532	GV	Fri. 1	J/M/F	B2	Rec.	実習	日本語中上級文法・語彙(秋冬)	OGAWA	小川佳子
48	395391	39J534	GV	Fri. 3	J/M/F	B2	Rec.	実習	日本語中上級文法・語彙(秋冬)	FURUKAWA	古川由理子
49	395092	39J622	KV	Mon. 4	J/M/F	B2	Rec.	実習	日本語中上級漢字・語彙(秋冬)	NISHIMURA	西村多恵
50	395093	39J624	KV	Tue. 2	J/M/F	B2	Rec.	実習	日本語中上級漢字・語彙(秋冬)	HARADA	原田佳代子
51	395094	39J626	KV	Wed. 1	J/M/F	B2	Rec.	実習	日本語中上級漢字・語彙(秋冬)	KITAGAWA	北川美香
52	395095	39J628	KV	Wed. 4	J/M/F	B2	Rec.	実習	日本語中上級漢字・語彙(秋冬)	UEDA	上田安希子
53	395096	39J630	KV	Thu. 3	J/M/F	B2	Rec.	実習	日本語中上級漢字・語彙(秋冬)	ARASHIMA	荒島和子
54	395097	39J632	KV	Fri. 2	J/M/F	B2	Rec.	実習	日本語中上級漢字・語彙(秋冬)	FURUKAWA	古川由理子

M Code	J Code	Category	Day・Period	Program	Level	Type	種別	授業科目名	Instructor(s)	教員	
J/M/F (C1) Japanese Language Subjects 日本語実習科目											
55	395099	39J142	RDG	Mon. 2	J/M/F	C1	Rec.	実習	日本語上級読解(秋冬)	CHIDA	千田愛
56	395100	39J144	RDG	Wed. 1	J/M/F	C1	Rec.	実習	日本語上級読解(秋冬)	NISHIKAWA	西川真理子
57	395101	39J146	RDG	Wed. 4	J/M/F	C1	Rec.	実習	日本語上級読解(秋冬)	NAKATA	中田一志
58	395102	39J148	RDG	Thu. 1	J/M/F	C1	Rec.	実習	日本語上級読解(秋冬)	TANAKA. S	田中里美
59	395103	39J150	RDG	Thu. 4	J/M/F	C1	Rec.	実習	日本語上級読解(秋冬)	NAKAJIMA. T	中島敬之
60	395104	39J152	RDG	Fri. 1	J/M/F	C1	Rec.	実習	日本語上級読解(秋冬)	HIRANO	平野莉江子
61	395105	39J242	LIS	Mon. 1	J/M/F	C1	Rec.	実習	日本語上級聴解(秋冬)	CHIDA	千田愛
62	395106	39J244	LIS	Mon. 3	J/M/F	C1	Rec.	実習	日本語上級聴解(秋冬)	IWADE	岩出雪乃
63	395107	39J246	LIS	Tue. 1	J/M/F	C1	Rec.	実習	日本語上級聴解(秋冬)	SOGAWA	十川理絵
64	395108	39J248	LIS	Wed. 2	J/M/F	C1	Rec.	実習	日本語上級聴解(秋冬)	IWAI. Y	岩井康雄
65	395109	39J250	LIS	Wed. 3	J/M/F	C1	Rec.	実習	日本語上級聴解(秋冬)	HATANO	波多野吉徳
66	395110	39J252	LIS	Thu. 5	J/M/F	C1	Rec.	実習	日本語上級聴解(秋冬)	OSAKI	大崎紀子
67	395111	39J254	LIS	Fri. 1	J/M/F	C1	Rec.	実習	日本語上級聴解(秋冬)	FURUKAWA	古川由理子
68	395310	39J342	WRT	Mon. 3	J/M/F	C1	Rec.	実習	日本語上級文章表現(秋冬)	OGURA	小倉慶郎
69	395311	39J344	WRT	Tue. 2	J/M/F	C1	Rec.	実習	日本語上級文章表現(秋冬)	SUGIYAMA	杉山さやか
70	395312	39J346	WRT	Wed. 1	J/M/F	C1	Rec.	実習	日本語上級文章表現(秋冬)	MINOKAWA	蓑川恵理子
71	395313	39J348	WRT	Wed. 5	J/M/F	C1	Rec.	実習	日本語上級文章表現(秋冬)	HIROKAWA	廣川直幸
72	395314	39J350	WRT	Thu. 1	J/M/F	C1	Rec.	実習	日本語上級文章表現(秋冬)	YUASA	湯浅章子
73	395315	39J352	WRT	Thu. 3	J/M/F	C1	Rec.	実習	日本語上級文章表現(秋冬)	YAMAMOTO. K	山本一也
74	395116	39J442	SPK	Mon. 2	J/M/F	C1	Rec.	実習	日本語上級口頭表現(秋冬)	OGURA	小倉慶郎
75	395117	39J444	SPK	Tue. 1	J/M/F	C1	Rec.	実習	日本語上級口頭表現(秋冬)	KASAMATSU	笠松瑞子
76	395118	39J446	SPK	Wed. 1	J/M/F	C1	Rec.	実習	日本語上級口頭表現(秋冬)	TANAKA. M	田中舞
77	395119	39J448	SPK	Wed. 3	J/M/F	C1	Rec.	実習	日本語上級口頭表現(秋冬)	IMADA	今田恵美
78	395120	39J450	SPK	Thu. 2	J/M/F	C1	Rec.	実習	日本語上級口頭表現(秋冬)	HATANO	波多野吉徳
79	395121	39J452	SPK	Fri. 3	J/M/F	C1	Rec.	実習	日本語上級口頭表現(秋冬)	FUJII. M	藤井みゆき
80	395124	39J542	GV	Mon. 4	J/M/F	C1	Rec.	実習	日本語上級文法・語彙(秋冬)	IWADE	岩出雪乃
81	395125	39J544	GV	Tue. 2	J/M/F	C1	Rec.	実習	日本語上級文法・語彙(秋冬)	NAKATA	中田一志
82	395126	39J546	GV	Wed. 3	J/M/F	C1	Rec.	実習	日本語上級文法・語彙(秋冬)	UEDA	上田安希子
83	395127	39J548	GV	Thu. 2	J/M/F	C1	Rec.	実習	日本語上級文法・語彙(秋冬)	YAMAZAWA	山澤園子
84	395128	39J550	GV	Fri. 2	J/M/F	C1	Rec.	実習	日本語上級文法・語彙(秋冬)	KISHIDA	岸田泰浩
85	395129	39J552	GV	Fri. 4	J/M/F	C1	Rec.	実習	日本語上級文法・語彙(秋冬)	ATSUTA	熱田万美
86	395130	39J642	KV	Mon. 1	J/M/F	C1	Rec.	実習	日本語上級漢字・語彙(秋冬)	YAMAMURA	山村貴美子
87	395131	39J644	KV	Wed. 2	J/M/F	C1	Rec.	実習	日本語上級漢字・語彙(秋冬)	KUBOTA	久保田ゆかり
88	395132	39J646	KV	Wed. 4	J/M/F	C1	Rec.	実習	日本語上級漢字・語彙(秋冬)	KAWASHIMA	川島信恵
89	395133	39J648	KV	Thu. 2	J/M/F	C1	Rec.	実習	日本語上級漢字・語彙(秋冬)	HARIMA	播磨涼子
90	395134	39J650	KV	Thu. 5	J/M/F	C1	Rec.	実習	日本語上級漢字・語彙(秋冬)	NONAKA	野中篤
91	395235	39J652	KV	Fri. 2	J/M/F	C1	Rec.	実習	日本語上級漢字・語彙(秋冬)	ADACHI	足立幸子

M Code	J Code	Category	Day・Period	Program	Level	Type	種別	授業科目名	Instructor(s)	教員	
J/M (B2) Research Subjects 研究 科 目											
92	395140	39JN00	LIN	Mon. 4	J/M	B2	Lec./Sem.	講義/演習	日本語学研究基礎(秋冬)1	YAMAKAWA	山川太
93	395141	39JN02	LIN	Wed. 3	J/M	B2	Lec./Sem.	講義/演習	日本語学研究基礎(秋冬)2	NAKATA	中田一志
94	395142	39JN04	LIN	Wed. 5	J/M	B2	Lec./Sem.	講義/演習	日本語学研究基礎(秋冬)3	SHOJI	莊司育子
95	395143	39JN06	LIN	Fri. 2	J/M	B2	Lec./Sem.	講義/演習	日本語学研究基礎(秋冬)4	TSUTA	蔦清行
96	395144	39JN08	LIN	Fri. 4	J/M	B2	Lec./Sem.	講義/演習	日本語学研究基礎(秋冬)5	KISHIDA	岸田泰浩
97	395155	39JE02	EDU	Mon. 5	J/M	B2	Lec./Sem.	講義/演習	日本語教育学研究基礎(秋冬)1	TAKAI	高井美穂
98	395156	39JE04	EDU	Wed. 2	J/M	B2	Lec./Sem.	講義/演習	日本語教育学研究基礎(秋冬)2	KOMORI	小森万里
99	395157	39JE06	EDU	Fri. 3	J/M	B2	Lec./Sem.	講義/演習	日本語教育学研究基礎(秋冬)3	SUZUKI. Y	鈴木由香里
100	395166	39JT02	THO	Mon. 1	J/M	B2	Lec./Sem.	講義/演習	日本思想文化学研究基礎(秋冬)2	MOTOBAYASHI	本林靖久
101	395167	39JT04	THO	Mon. 2	J/M	B2	Lec./Sem.	講義/演習	日本思想文化学研究基礎(秋冬)3	KATO	加藤均
102	395168	39JT06	THO	Tue. 1	J/M	B2	Lec./Sem.	講義/演習	日本思想文化学研究基礎(秋冬)4	MATSUMURA etc.	松村薫子ほか
103	395169	39JT08	THO	Tue. 2	J/M	B2	Lec./Sem.	講義/演習	日本思想文化学研究基礎(秋冬)5	WATANABE. C	渡邊親文
104	395170	39JT10	THO	Wed. 4	J/M	B2	Lec./Sem.	講義/演習	日本思想文化学研究基礎(秋冬)6	MATSUMURA	松村薫子
105	395182	39JH04	HIS	Mon. 4	J/M	B2	Lec./Sem.	講義/演習	日本歴史文化学研究基礎(秋冬)3	FUKUMITSU	福光敬子
106	395183	39JH06	HIS	Tue. 2	J/M	B2	Lec./Sem.	講義/演習	日本歴史文化学研究基礎(秋冬)4	SANO	佐野方郁
107	395185	39JH10	HIS	Thu. 4	J/M	B2	Lec./Sem.	講義/演習	日本歴史文化学研究基礎(秋冬)6	INOMO	井面舞
108	395186	39JH12	HIS	Fri. 1	J/M	B2	Lec./Sem.	講義/演習	日本歴史文化学研究基礎(秋冬)7	SATO. S	佐藤早紀子
109	395191	39JL02	LIT	Mon. 3	J/M	B2	Lec./Sem.	講義/演習	日本文献文化学研究基礎(秋冬)2	GONOJI	五之治昌比呂
110	395193	39JL06	LIT	Thu. 2	J/M	B2	Lec./Sem.	講義/演習	日本文献文化学研究基礎(秋冬)4	HONDA	本多朱里
111	395194	39JL08	LIT	Fri. 4	J/M	B2	Lec./Sem.	講義/演習	日本文献文化学研究基礎(秋冬)5	SHIBATA	柴田芳成
112	395201	39JC02	CON	Mon. 4	J/M	B2	Lec./Sem.	講義/演習	日本近現代文化学研究基礎(秋冬)2	NUKITA	貫田優子
113	395202	39JC04	CON	Wed. 3	J/M	B2	Lec./Sem.	講義/演習	日本近現代文化学研究基礎(秋冬)3	IWAI. S	岩井茂樹
114	395203	39JC06	CON	Thu. 3	J/M	B2	Lec./Sem.	講義/演習	日本近現代文化学研究基礎(秋冬)4	LIU LINGFANG	劉玲芳
115	395204	39JC08	CON	Thu. 4	J/M	B2	Lec./Sem.	講義/演習	日本近現代文化学研究基礎(秋冬)5	BEREZIKOVA. T	ベレジコワ, T.
116	395215	39JS02	SOC	Wed. 3	J/M	B2	Lec./Sem.	講義/演習	日本社会文化学研究基礎(秋冬)2	ITO	伊藤敏雄
117	395216	39JS04	SOC	Wed. 4	J/M	B2	Lec./Sem.	講義/演習	日本社会文化学研究基礎(秋冬)3	NAKAMURA	中村友一
J/M (C1) Research Subjects 研究 科 目											
118	395135	39JN22	LIN	Mon. 5	J/M	C1	Lec./Sem.	講義/演習	日本語学研究(秋冬)1	IMAI	今井忍
119	395136	39JN24	LIN	Wed. 4	J/M	C1	Lec./Sem.	講義/演習	日本語学研究(秋冬)2	IWAI. Y	岩井康雄
120	395137	39JN26	LIN	Thu. 4	J/M	C1	Lec./Sem.	講義/演習	日本語学研究(秋冬)3	DUONG	ズオン, T.
121	395150	39JE22	EDU	Mon. 4	J/M	C1	Lec./Sem.	講義/演習	日本語教育学研究(秋冬)1	YAMATO	大和祐子
122	395151	39JE24	EDU	Fri. 4	J/M	C1	Lec./Sem.	講義/演習	日本語教育学研究(秋冬)2	TACHIKAWA	立川真紀絵
123	395160	39JT22	THO	Wed. 2	J/M	C1	Lec./Sem.	講義/演習	日本思想文化学研究(秋冬)1	ブレニナ, Y.	BURENINA
124	395175	39JH22	HIS	Mon. 5	J/M	C1	Lec./Sem.	講義/演習	日本歴史文化学研究(秋冬)1	SANO	佐野方郁
125	395176	39JH24	HIS	Thu. 1	J/M	C1	Lec./Sem.	講義/演習	日本歴史文化学研究(秋冬)2	TAIRA	平良聡弘
126	395177	39JH26	HIS	Thu. 3	J/M	C1	Lec./Sem.	講義/演習	日本歴史文化学研究(秋冬)3	INOMO	井面舞
127	395178	39JH28	HIS	Thu. 4	J/M	C1	Lec./Sem.	講義/演習	日本歴史文化学研究(秋冬)4	YAMAMOTO. K	山本一也
128	395179	39JH30	HIS	Fri. 3	J/M	C1	Lec./Sem.	講義/演習	日本歴史文化学研究(秋冬)5	KOYAMA	小山有子
129	395285	39JL22	LIT	Thu. 3	J/M	C1	Lec./Sem.	講義/演習	日本文献文化学研究(秋冬)1	HONDA	本多朱里
130	395286	39JL24	LIT	Fri. 1	J/M	C1	Lec./Sem.	講義/演習	日本文献文化学研究(秋冬)2	ADACHI	足立幸子
131	395287	39JL26	LIT	Fri. 2	J/M	C1	Lec./Sem.	講義/演習	日本文献文化学研究(秋冬)3	MIZUNO	水野亜紀子
132	395288	39JL28	LIT	Fri. 3	J/M	C1	Lec./Sem.	講義/演習	日本文献文化学研究(秋冬)4	SHIBATA	柴田芳成
133	395195	39JC22	CON	Mon. 2	J/M	C1	Lec./Sem.	講義/演習	日本近現代文化学研究(秋冬)1	MOTOBAYASHI	本林靖久
134	395196	39JC24	CON	Mon. 3	J/M	C1	Lec./Sem.	講義/演習	日本近現代文化学研究(秋冬)2	NUKITA	貫田優子
135	395197	39JC26	CON	Fri. 4	J/M	C1	Lec./Sem.	講義/演習	日本近現代文化学研究(秋冬)3	KOYAMA	小山有子
136	395210	39JS22	SOC	Wed. 5	J/M	C1	Lec./Sem.	講義/演習	日本社会文化学研究(秋冬)1	AOYAMA	青山志保

M Code	J Code	Category	Day・Period	Program	Level	Type	種別	授業科目名	Instructor(s)	教員	
Directed Research & Reading Subjects 日本語・日本文化研究 / 研修指導 (JDR)											
137	—	39J040	JDR	Tue. 3	J	—	Sem.	演習	日本語・日本文化研究指導(秋冬)	IMAI	今井忍
138	—	39J041	JDR	Tue. 4	J	—	Sem.	演習	日本語・日本文化研究指導(秋冬)	IWAI. S	岩井茂樹
139	—	39J042	JDR	Tue. 4	J	—	Sem.	演習	日本語・日本文化研究指導(秋冬)	IWAI. Y	岩井康雄
140	—	39J043	JDR	Tue. 3	J	—	Sem.	演習	日本語・日本文化研究指導(秋冬)	KISHIDA	岸田泰浩
141	—	39J044	JDR	Tue. 4	J	—	Sem.	演習	日本語・日本文化研究指導(秋冬)	GONOJI	五之治昌比呂
142	—	39J045	JDR	Tue. 4	J	—	Sem.	演習	日本語・日本文化研究指導(秋冬)	KOMORI	小森万里
143	—	39J046	JDR	Tue. 4	J	—	Sem.	演習	日本語・日本文化研究指導(秋冬)	SANO	佐野方郁
144	—	39J047	JDR	Tue. 3	J	—	Sem.	演習	日本語・日本文化研究指導(秋冬)	SHIBATA	柴田芳成
145	—	39J048	JDR	Tue. 4	J	—	Sem.	演習	日本語・日本文化研究指導(秋冬)	TAKAI	高井美穂
146	—	39J049	JDR	Tue. 4	J	—	Sem.	演習	日本語・日本文化研究指導(秋冬)	TACHIKAWA	立川真紀絵
147	—	39J050	JDR	Tue. 3	J	—	Sem.	演習	日本語・日本文化研究指導(秋冬)	TSUTA	蔦清行
148	—	39J051	JDR	Tue. 3	J	—	Sem.	演習	日本語・日本文化研究指導(秋冬)	NAKATA	中田一志
149	—	39J052	JDR	Tue. 4	J	—	Sem.	演習	日本語・日本文化研究指導(秋冬)	MATSUMURA	松村薫子
150	—	39J053	JDR	Tue. 4	J	—	Sem.	演習	日本語・日本文化研究指導(秋冬)	MIZUNO	水野亜紀子
151	—	39J054	JDR	Tue. 5	J	—	Sem.	演習	日本語・日本文化研究指導(秋冬)	SHOJI	荘司育子
152	—	39J055	JDR	Tue. 3	J	—	Sem.	演習	日本語・日本文化研究指導(秋冬)	YAMAKAWA	山川太
153	—	39J056	JDR	Tue. 3	J	—	Sem.	演習	日本語・日本文化研究指導(秋冬)	YAMATO	大和祐子
154	—	39J058	JDR	Tue. 3	J	—	Sem.	演習	日本語・日本文化研修指導(秋冬)	SANO	佐野方郁
155	—	39J059	JDR	Tue. 3	J	—	Sem.	演習	日本語・日本文化研修指導(秋冬)	MATSUMURA	松村薫子

M Code	J Code	Category	Day・Period	Program	Level	Type	種別	授業科目名	Instructor(s)	教員	
M (A2) Japanese Language Subjects 日本語実習科目 (MGV)											
156	395001	—	MGV α	Mon. 2	M	A2	Rec.	実習	現代日本語中級文法・語彙 α (秋冬)	TAKAI	高井美穂
157	395001	—	MGV α	Tue. 2	M	A2	Rec.	実習		TACHIKAWA	立川真紀絵
158	395001	—	MGV α	Thu. 2	M	A2	Rec.	実習		KOZAKURA	小桜真未
159	395001	—	MGV α	Fri. 2	M	A2	Rec.	実習		OGAWA	小川佳子
160	395002	—	MGV β	Mon. 1	M	A2	Rec.	実習	現代日本語中級文法・語彙 β (秋冬)	MATSUSHIMA	松島弘枝
161	395002	—	MGV β	Wed. 2	M	A2	Rec.	実習		HATANO	波多野吉徳
M (B1) Japanese Language Subjects 日本語実習科目 (MGV)											
162	395003	—	MGV α 1	Mon. 2	M	B1	Rec.	実習	現代日本語中級文法・語彙 α (秋冬)	KAWABUCHI	川渕節子
163	395003	—	MGV α 1	Tue. 2	M	B1	Rec.	実習		KASAMATSU	笠松瑞子
164	395003	—	MGV α 1	Thu. 2	M	B1	Rec.	実習		NAMBA	南場尚子
165	395003	—	MGV α 1	Fri. 2	M	B1	Rec.	実習		NAKAJIMA	中嶋伸子
166	395004	—	MGV α 2	Mon. 2	M	B1	Rec.	実習	現代日本語中級文法・語彙 α (秋冬)	TANAKA. Y	田中泰子
167	395004	—	MGV α 2	Tue. 2	M	B1	Rec.	実習		LEE	李裕旋
168	395004	—	MGV α 2	Thu. 2	M	B1	Rec.	実習		FUJII. C	藤井千枝
169	395004	—	MGV α 2	Fri. 2	M	B1	Rec.	実習		HIGUCHI	樋口尊子
M (—) Research Subjects in English 英語による研究科目											
170	395165	—	THO	Thu. 1	M	—	Lec./Sem.	講義/演習	日本思想文化学研究基礎(秋冬)1	TAMAS	タマシ, C.
171	395180	—	HIS	Mon. 5	M	—	Lec./Sem.	講義/演習	日本歴史文化学研究基礎(秋冬)1	FUKUMITSU	福光敬子
172	395181	—	HIS	Wed. 1	M	—	Lec./Sem.	講義/演習	日本歴史文化学研究基礎(秋冬)2	BEKE	ベーケー, L.
173	395190	—	LIT	Wed. 5	M	—	Lec./Sem.	講義/演習	日本文献文化学研究基礎(秋冬)1	CARDI	カルディ, L.
174	395200	—	CON	Tue. 1	M	—	Lec./Sem.	講義/演習	日本近現代文化学研究基礎(秋冬)1	WATANABE. C	渡邊親文
175	395217	—	SOC	Fri. 4	M	—	Lec./Sem.	講義/演習	日本社会文化学研究基礎(秋冬)1	CARMONA	カルモナ, D.
Directed Research and Reading Subjects 日本語日本文化専門演習 (MDR)											
176	395220	—	MDR	Tue. 3	M	—	Sem.	演習	日本語日本文化専門演習(秋冬)	IWAI. S	岩井茂樹
177	395221	—	MDR	Tue. 3	M	—	Sem.	演習	日本語日本文化専門演習(秋冬)	IWAI. Y	岩井康雄
178	395222	—	MDR	Tue. 3	M	—	Sem.	演習	日本語日本文化専門演習(秋冬)	GONOJI	五之治昌比呂
179	395223	—	MDR	Tue. 3	M	—	Sem.	演習	日本語日本文化専門演習(秋冬)	KOMORI	小森万里
180	395224	—	MDR	Tue. 3	M	—	Sem.	演習	日本語日本文化専門演習(秋冬)	TAKAI	高井美穂
181	395225	—	MDR	Tue. 3	M	—	Sem.	演習	日本語日本文化専門演習(秋冬)	TACHIKAWA	立川真紀絵
182	395226	—	MDR	Tue. 3	M	—	Sem.	演習	日本語日本文化専門演習(秋冬)	MATSUOKA	松岡里奈
183	395227	—	MDR	Tue. 3	M	—	Sem.	演習	日本語日本文化専門演習(秋冬)	MIZUNO	水野亜紀子
Independent Studies Subjects 自主研究科目 (MIS)											
184	395230	—	MIS	Tue. 5	M	—	Sem.	演習	自主研究(秋冬)	IWAI. S	岩井茂樹
185	395231	—	MIS	Tue. 5	M	—	Sem.	演習	自主研究(秋冬)	GONOJI	五之治昌比呂
186	395232	—	MIS	Tue. 5	M	—	Sem.	演習	自主研究(秋冬)	TSUTA	薦清行
187	395233	—	MIS	Tue. 5	M	—	Sem.	演習	自主研究(秋冬)	MATSUMURA	松村薫子
188	395234	—	MIS	Tue. 5	M	—	Sem.	演習	自主研究(秋冬)	MIZUNO	水野亜紀子

じ かん わり
時 間 割

Weekly Schedule

令和2年度秋～冬学期時間割表

月		火		水		木		金			
必修	U1	UJPN	金田英里	UJPN	小南淳子	UJPN	山澤園子	UJPN	眞下恭子	UJPN	山本幸枝
必修	U2	UJPN	久保るみ	UJPN	小林可奈子	UJPN	林和子	UJPN	荒島和子	UJPN	藤井みゆき
必修	U3	UJPN	石橋玲央	UJPN	福島薫	UJPN	渡邊祥子	UJPN	山本修	UJPN	日比伊奈穂
必修	U4	UJPN	宮崎さとみ	UJPN	廣坂直子	UJPN	古賀静香	UJPN	山村貴美子	UJPN	内田孝
必修	U5	UJPN	三原千佳	UJPN	矢田まゆ子	UJPN	鈴木真理子	UJPN	松本恵美子	UJPN	谷口萌子
必修	U6	UJPN	小林潔子	UJPN	大内豊久	UJPN	眞田聡美	UJPN	三登由利子	UJPN	古田朋子
必修	U7	UJPN	原田佳代子	UJPN	大塚淳子	UJPN	宮崎さとみ	FJPN	小林可奈子	FJPN	吉川夏渚子
必修	F2	FJPN	大塚淳子	FJPN	谷口萌子	FJPN	田中泰子	FJPN	福富奈美	FJPN	藤井千枝
必修	F3	FJPN	山本修	FJPN	井手恭子	FJPN	田中泰子	THO	タマシ、C.	KV	中嶋伸子
必修	M	MGVβ	松島弘枝	CON	渡邊親文	B2 KV	北川美香	GV	藤井千枝	B1	小川佳子
選択	J/M/F	B1 RDG	金居明生	B1 WRT	李裕旋	B2 RDG	久保田ゆかり	B2 GV	フナーナー万裕子	B2 KV	古川由理子
選択	J/M/F	B2 LIS	川瀬節子	B2 GV	原田佳代子	B2 SPK	大上陽子	B2 SPK	フナーナー万裕子	C1 LIS	小川由理子
選択	J/M/F	B2 SPK	田中泰子	B2 RDG	林由華	C1 RDG	西川真理子	C1 RDG	田中里美	C1 RDG	平野莉江子
選択	J/M/F	C1 KV	山村真美子	B2 RDG	十川理絵	C1 SPK	田中舞	C1 WRT	湯浅幸子	B2 HIS	佐藤早紀子
選択	J/M/F	C1 LIS	千田愛	C1 SPK	笠松瑞子	C1 WRT	義川恵理子	C1 HIS	平良聡弘	C1 LIS	足立幸子
選択	J/M	THO	本林靖久	B2 THO	松村薫子ほか	HIS	ベークー、L.	C1 HIS		C1 LIT	
必修	U1	UJPN	金田英里	UJPN	小南淳子	UJPN	山澤園子	UJPN	眞下恭子	UJPN	山本幸枝
必修	U2	UJPN	久保るみ	UJPN	小林可奈子	UJPN	林和子	UJPN	荒島和子	UJPN	藤井みゆき
必修	U3	UJPN	石橋玲央	UJPN	福島薫	UJPN	渡邊祥子	UJPN	山本修	UJPN	日比伊奈穂
必修	U4	UJPN	宮崎さとみ	UJPN	廣坂直子	UJPN	古賀静香	UJPN	山村貴美子	UJPN	内田孝
必修	U5	UJPN	三原千佳	UJPN	矢田まゆ子	UJPN	鈴木真理子	UJPN	松本恵美子	UJPN	谷口萌子
必修	U6	UJPN	小林潔子	UJPN	大内豊久	UJPN	眞田聡美	UJPN	三登由利子	UJPN	古田朋子
必修	U7	UJPN	原田佳代子	UJPN	大塚淳子	UJPN	宮崎さとみ	FJPN	小林可奈子	FJPN	吉川夏渚子
必修	F2	FJPN	大塚淳子	FJPN	谷口萌子	FJPN	田中泰子	FJPN	福富奈美	FJPN	藤井千枝
必修	F3	FJPN	山本修	FJPN	井手恭子	FJPN	田中泰子	MGVα	小桜真未	A2	小川佳子
必修	M	MGVα	高井美穂	A2 MGVα	立川真紀絵	A2 MGVβ	波多野吉徳	B1 MGVα1	南場尚子	B1	中嶋伸子
必修	M	B1 MGVα1	川瀬節子	B1 MGVα1	笠松瑞子	B2 GV	井手恭子	B1 MGVα2	藤井千枝	B1	樋口尊子
必修	M	B1 MGVα2	田中泰子	B1 MGVα2	李裕旋	B2 LIS	義川恵理子	B2 KV	田中里美	B2	古川由理子
選択	J/M/F	B2 RDG	松島弘枝	B2 KV	原田佳代子	C1 KV	久保田ゆかり	B2 RDG	フナーナー万裕子	B2 WRT	鈴木由香里
選択	J/M/F	B2 WRT	坂田達紀	C1 WRT	林由華	C1 LIS	岩井康雄	C1 GV	山澤園子	B2 WRT	足立幸子
選択	J/M/F	C1 RDG	千田愛	C1 WRT	杉山さやか	B2 EDU	小森万里	C1 KV	福富奈美	C1 KV	岸田泰浩
選択	J/M/F	C1 SPK	小倉慶郎	B2 THO	渡邊親文	C1 THO	ブルニナ、Y.	C1 SPK	波多野吉徳	C1 GV	鷲野清行
選択	J/M	C1 CON	本林靖久	C1 GV	中田一志	C1 THO		C1 SPK	本多朱里	B2 LIN	
選択	J/M	B2 THO	加藤均	B2 HIS	佐野方郁	C1 THO		C1 LIT		C1 LIT	

I

II

Fall and Winter Terms, 2020

Monday			Tuesday			Wednesday			Thursday			Friday		
Rq	U1	UJPN KANEDA	Rq	U1	UJPN	Rq	U1~4	UJPN YAMAZAWA	Rq	U1~4	UJPN MASHITA	Rq	U1~4	UJPN YAMAMOTO, Y
Rq	U2	UJPN KUBO	Rq	U2	UJPN	Rq	U1~4	UJPN HAYASHI, K	Rq	U1~4	UJPN ARASHIMA	Rq	U1~4	UJPN FUJII, M
Rq	U3	UJPN ISHIBASHI	Rq	U3	UJPN	Rq	U1~4	UJPN WATANABE, Y	Rq	U1~4	UJPN YAMAMOTO, O	Rq	U1~4	UJPN HIBI
Rq	U4	UJPN MIYAZAKI	Rq	U4	UJPN HIROSAKA	Rq	U5	UJPN KOGA	Rq	U5	UJPN YAMAMURA	Rq	U5	UJPN UCHIDA
Rq	U5	UJPN MIHARA, C	Rq	U5	UJPN YADA	Rq	U6	UJPN SUZUKI, M	Rq	U6	UJPN MATSUMOTO, E	Rq	U6	UJPN TANIGUCHI
Rq	U6	UJPN KOBAYASHI, K	Rq	U6	UJPN OUCHI	Rq	U7	UJPN SANADA	Rq	U7	UJPN MITO	Rq	U7	UJPN FURUTA
Rq	U7	UJPN HARADA	Rq	U7	UJPN OTHUKA	Rq	F2	UJPN MIYAZAKI	Rq	F2	UJPN KOBAYASHI, K	Rq	F2	UJPN YOSHIKAWA
Rq	F2	UJPN OTHUKA	Rq	F2	UJPN TANIGUCHI	Rq	F3	UJPN TANAKA, Y	Rq	F3	UJPN FUKUTOMI	Rq	F3	UJPN FUJII, C
Rq	F3	UJPN YAMAMOTO, O	Rq	F3	UJPN IDE	Rq	F3	UJPN TANAKA, Y	Rq	F3	UJPN TAMA	Rq	F3	UJPN YOSHIKAWA
Rq	E1	A2 MGV β MATSUSHIMA	Rq	M	CON WATANABE, C	Rq	E1	J/M/F KITAGAWA	Rq	M	THO	Rq	E1	B1 KV NAKAJIMA
E1	J/M/F	B1 RDG KANAI	E1	J/M/F	B1 WRT LEE	E1	J/M/F	B2 RDG KUBOTA	E1	J/M/F	B2 GV FUJII, C	E1	J/M/F	B2 GV OGAWA
E1	J/M/F	B2 LIS KAWABUCHI	E1	J/M/F	B2 GV HARADA	E1	J/M/F	B2 SPK OOU	E1	J/M/F	B2 SPK FEENER	E1	J/M/F	C1 LIS FURUKAWA
E1	J/M/F	B2 SPK TANAKA, Y	E1	J/M/F	B2 RDG HAYASHI, Y	E1	J/M/F	C1 RDG NISHIKAWA	E1	J/M/F	C1 RDG TANAKA, S	E1	J/M/F	C1 RDG HIRANO
E1	J/M/F	C1 KV YAMAMURA	E1	J/M/F	C1 LIS SOGAWA	E1	J/M/F	C1 SPK TANAKA, M	E1	J/M/F	C1 WRT YUASA	E1	J/M	B2 HIS SATO, S
E1	J/M/F	C1 LIS CHIDA	E1	J/M/F	C1 SPK KASAMATSU	E1	J/M/F	C1 WRT MINOKAWA	E1	J/M	C1 HIS TAIRA	E1	J/M	C1 LIT ADACHI
E1	J/M	B2 THO MOTOBAYASHI	E1	J/M	B2 THO	E1	M	HIS BEKE						
Rq	U1	UJPN KANEDA	Rq	U1	UJPN KOMINAMI	Rq	U1~4	UJPN YAMAZAWA	Rq	U1~4	UJPN MASHITA	Rq	U1~4	UJPN YAMAMOTO, Y
Rq	U2	UJPN KUBO	Rq	U2	UJPN KOBAYASHI, K	Rq	U1~4	UJPN HAYASHI, K	Rq	U1~4	UJPN ARASHIMA	Rq	U1~4	UJPN FUJII, M
Rq	U3	UJPN ISHIBASHI	Rq	U3	UJPN FUKUSHIMA	Rq	U1~4	UJPN WATANABE, Y	Rq	U1~4	UJPN YAMAMOTO, O	Rq	U1~4	UJPN HIBI
Rq	U4	UJPN MIYAZAKI	Rq	U4	UJPN HIROSAKA	Rq	U5	UJPN KOGA	Rq	U5	UJPN YAMAMURA	Rq	U5	UJPN UCHIDA
Rq	U5	UJPN MIHARA, C	Rq	U5	UJPN YADA	Rq	U6	UJPN SUZUKI, M	Rq	U6	UJPN MATSUMOTO, E	Rq	U6	UJPN TANIGUCHI
Rq	U6	UJPN KOBAYASHI, K	Rq	U6	UJPN OUCHI	Rq	U7	UJPN SANADA	Rq	U7	UJPN MITO	Rq	U7	UJPN FURUTA
Rq	U7	UJPN HARADA	Rq	U7	UJPN OTHUKA	Rq	F2	UJPN MIYAZAKI	Rq	F2	UJPN KOBAYASHI, K	Rq	F2	UJPN YOSHIKAWA
Rq	F2	UJPN OTHUKA	Rq	F2	UJPN TANIGUCHI	Rq	F3	UJPN TANAKA, Y	Rq	F3	UJPN FUKUTOMI	Rq	F3	UJPN FUJII, C
Rq	F3	UJPN YAMAMOTO, O	Rq	F3	UJPN IDE	Rq	M	A2 MGV β HATANANO	Rq	M	MGV α KOZAKURA	Rq	M	MGV α OGAWA
Rq	M	A2 MGV α TAKAI	Rq	M	A2 MGV α KASAMATSU	Rq	E1	J/M/F B1 GV TANAKA, M	Rq	M	B1 MGV α 1 NAMBA	Rq	M	B1 MGV α 1 NAKAJIMA
Rq	M	B1 MGV α 1 KAWABUCHI	Rq	M	B1 MGV α 1 LEE	Rq	E1	J/M/F B2 GV IDE	Rq	M	B1 MGV α 2 FUJII, C	Rq	M	B1 MGV α 2 HIGUCHI
Rq	M	B1 MGV α 2 TANAKA, Y	Rq	M	B1 MGV α 2 TACHIKAWA	Rq	E1	J/M/F B2 LIS MINOKAWA	Rq	E1	J/M/F B2 LIS TANAKA, S	Rq	E1	B2 KV FURUKAWA
E1	J/M/F	B2 RDG MATSUSHIMA	E1	J/M/F	B2 KV HARADA	E1	J/M/F	C1 KV KUBOTA	E1	J/M/F	B2 RDG FEENER	E1	J/M/F	B2 WRT SUZUKI, Y
E1	J/M/F	B2 WRT SAKATA	E1	J/M/F	B2 WRT HAYASHI, Y	E1	J/M/F	C1 LIS IWAI, Y	E1	J/M/F	C1 GV YAMAZAWA	E1	J/M/F	C1 KV ADACHI
E1	J/M/F	C1 RDG CHIDA	E1	J/M/F	C1 WRT SUGYAMA	E1	J/M	B2 EDU KOMORI	E1	J/M/F	C1 KV HARIMA	E1	J/M/F	C1 GV KISHIDA
E1	J/M/F	C1 SPK OGURA	E1	J/M	B2 THO WATANABE, C	E1	J/M	C1 THO BURENINA	E1	J/M/F	C1 SPK HATANANO	E1	J/M	B2 LIN TSUTA
E1	J/M	C1 CON MOTOBAYASHI	E1	J/M/F	C1 GV NAKATA	E1	J/M	C1 THO	E1	J/M	B2 LIT HONDA	E1	J/M	C1 LIT MIZUNO
E1	J/M	B2 THO KATO	E1	J/M	B2 HIS SANO									

I

II

Monday			Tuesday			Wednesday			Thursday			Friday			
Rq	F3	FJPN YAMAMOTO. O	Rq	U	JC	Rq	EI	U	PHYS SATO. T	Rq	U	MATH TAKAHASHI	Rq	U	CHEM ISOBE
Rq	F1	MATH FUJI	Rq	U	JC KOMINAMI	Rq	EI	U	PHYS SHIMODA	Rq	U	MATH TAHARA	Rq	U	CHEM TORIUMI
Rq	F1	PHYS OZAWA	Rq	U	JC MOTOBAYASHI	Rq	EI	U	PHYS TOCHIO	Rq	U	MATH FUJI	Rq	U	CHEM NAITO
EI	J/M/F	A2 RDG MIHARA. C	Rq	U	JC WATANABE. C	Rq	EI	U	PHYS NAKABE	Rq	U	MATH MIYATA	Rq	U	CHEM HONMA
EI	J/M/F	B1 LIS NISHIMURA	Rq	F3	FJPN IDE	Rq	EI	U	PHYS HANDA. KAT	Rq	U	MATH MORITA	Rq	U	CHEM MATSUMOTO. A
EI	J/M/F	B2 WRT ISHIBASHI	Rq	F1	FJPN SHOJI	Rq	EI	U	BIO KANAZAWA	Rq	F3	MATH YAMADA	Rq	F1	FJPN FUJII. C
EI	J/M/F	B2 WRT MATSUSHIMA	Rq	M	MDR IWAI. S	Rq	EI	U	BIO GOTO	Rq	F1	FJPN FUKUTOMI	Rq	F1	HIST INOUE. N
EI	J/M/F	C1 LIS IWADE	Rq	M	MDR IWAI. S	Rq	F3	FJPN TANAKA. Y	Rq	F1	CHEM NAITO	EI	J/M/F	A2 KV HIGUCHI	
EI	J/M/F	C1 WRT OGURA	Rq	M	MDR GONOJI	Rq	F1	POLI KUBOTA	EI	J/M/F	A2 SPK MITO	EI	J/M/F	B1 GV FURUKAWA	
EI	J/M	C1 CON NUKITA	Rq	M	MDR KOMORI	Rq	F1	MATH SAKANE	EI	J/M/F	B1 WRT NAMBA	EI	J/M/F	B2 GV ATARASHI	
EI	J/M	B2 LIT GONOJI	Rq	M	MDR TAKAI	EI	J/M/F	A2 GV IDE	EI	J/M/F	B2 GV KOZAKURA	EI	J/M/F	B2 LIS FUJII. M	
			Rq	M	MDR TACHIKAWA	EI	J/M/F	B1 SPK SANADA	EI	J/M/F	B2 KV ARASHIMA	EI	J/M/F	C1 SPK SUZUKI. Y	
			Rq	M	MDR MATSUOKA	EI	J/M/F	C1 GV UEDA	EI	J/M/F	B2 RDG MASHITA	EI	J/M	B2 EDU KOYAMA	
			Rq	M	MDR MIZUNO	EI	J/M/F	C1 LIS HATANANO	EI	J/M/F	C1 WRT YAMAMOTO. K	EI	J/M	C1 HIS MATSUOKA	
			Rq	J	JDR IMAI	EI	J/M/F	C1 SPK IMADA	EI	J/M	B2 CON LIU LINGFANG	EI	J/M	C1 LIT SHIBATA	
			Rq	J	JDR KISHIDA	EI	J/M	B2 SOC ITO	EI	J/M	C1 HIS INOMO				
			Rq	J	JDR SHIBATA	EI	J/M	B2 CON IWAI. S	EI	J/M	C1 LT HONDA				
			Rq	J	JDR TSUTA	EI	J/M	B2 LIN NAKATA							
			Rq	J	JDR NAKATA										
			Rq	J	JDR YAMAKAWA										
			Rq	J	JDR YAMATO										
			Rq	J	JDR SANO										
			Rq	J	JDR MATSUMURA										
Rq	F1	MATH FUJI	Rq	F1	JC ONISHI	Rq	EI	U	PHYS SATO. T	Rq	U	MATH TAKAHASHI	Rq	U	CHEM ISOBE
Rq	F1	PHYS OZAWA	Rq	F2-3	FJPN TSUTA	Rq	EI	U	PHYS SHIMODA	Rq	U	MATH TAHARA	Rq	U	CHEM TORIUMI
Rq	F2-3	MATH MORITA	Rq	U	UJPN IMAI	Rq	EI	U	PHYS TOCHIO	Rq	U	MATH FUJI	Rq	U	CHEM NAITO
EI	J/M/F	B1 SPK BABA	Rq	U	UJPN KISHIDA	Rq	EI	U	PHYS NAKABE	Rq	U	MATH MIYATA	Rq	U	CHEM HONMA
EI	J/M/F	B2 KV NISHIMURA	Rq	U	UJPN SHIBATA	Rq	EI	U	PHYS HANDA. KAT	Rq	U	MATH MORITA	Rq	U	CHEM MATSUMOTO. A
EI	J/M/F	C1 GV IWADE	Rq	U	UJPN SHOJI	Rq	EI	U	BIO KANAZAWA	Rq	U	MATH YAMADA	Rq	F1	HIST INOUE. N
EI	J/M	B2 CON NUKITA	Rq	U	UJPN YAMAKAWA	Rq	EI	U	BIO GOTO	Rq	F1	CHEM NAITO	EI	M	SOC CARMONA
EI	J/M	B2 HIS FUKUMITSU	Rq	U	UJPN YAMATO	Rq	F1	POLI IMURA	EI	J/M/F	A2 WRT ATSUTA	EI	J/M/F	B2 SPK ATARASHI	
EI	J/M	B2 LIN YAMAKAWA	Rq	J	JDR IWAI. S	Rq	F1	MATH SAKANE	EI	J/M/F	B1 RDG NONAKA	EI	J/M/F	C1 GV ATSUTA	
EI	J/M	C1 EDU YAMATO	Rq	J	JDR IWAI. Y	EI	J/M/F	A2 LIS IMADA	EI	J/M/F	B2 WRT OSAKI	EI	J/M	C1 CON KOYAMA	
			Rq	J	JDR GONOJI	EI	J/M/F	B1 KV HIROKAWA	EI	J/M/F	C1 RDG NAKAJIMA. T	EI	J/M	B2 LIN KISHIDA	
			Rq	J	JDR KOMORI	EI	J/M/F	B2 KV UEDA	EI	J/M	B2 HIS INOMO	EI	J/M	B2 LIT SHIBATA	
			Rq	J	JDR SANO	EI	J/M/F	C1 KV KAWASHIMA	EI	J/M	C1 HIS YAMAMOTO. K	EI	J/M	C1 EDU TACHIKAWA	
			Rq	J	JDR TAKAI	EI	J/M	B2 SOC NAKAMURA	EI	J/M	B2 CON BEREZIKOVA. T				
			Rq	J	JDR TACHIKAWA	EI	J/M/F	B2 WRT KOMORI	EI	J/M	C1 LIN DUONG				
			Rq	J	JDR MATSUMURA	EI	J/M/F	C1 RDG NAKATA							
			Rq	J	JDR MIZUNO	EI	J/M	B2 THO MATSUMURA							
						EI	J/M	C1 LIN IWAI. Y							
Rq	F2-3	MATH MORITA	EI	U	UJPN IMAI	EI	M	LIT CARDI	EI	J/M/F	B1 LIS TAKATSUKI				
EI	M	HIS FUKUMITSU	EI	U	UJPN YAMAKAWA	EI	J/M/F	B2 LIS KAWASHIMA	EI	J/M/F	B2 LIS ATSUTA				
EI	J/M/F	B2 SPK IWADE	EI	U	UJPN YAMATO	EI	J/M/F	C1 WRT HIROKAWA	EI	J/M/F	B2 SPK KONDO				
EI	J/M	B2 EDU TAKAI	Rq	J	JDR SHOJI	EI	J/M	C1 SOC AOYAMA	EI	J/M/F	C1 LIS OSAKI				
EI	J/M	C1 HIS SANO	EI	M	MIS IWAI. S	EI	J/M	B2 LIN SHOJI	EI	J/M/F	C1 KV NONAKA				
EI	J/M	C1 LIN IMAI	EI	M	MIS GONOJI										
			EI	M	MIS TSUTA										
			EI	M	MIS MATSUMURA										
			EI	M	MIS MIZUNO										

*Rq : Required EI : Electives RqEI : Required Electives

III

IV

V

U

Monday		Tuesday		Wednesday		Thursday		Friday		
UJPN U1 KANEDA	UJPN U1 KOMINAMI	UJPN U1~4 YAMAZAWA	UJPN U1~4 MASHITA	UJPN U1~4 YAMAMOTO, Y	I	UJPN U2 KUBO	UJPN U2 KOBAYASHI, KA	UJPN U1~4 HAYASHI, K	UJPN U1~4 ARASHIMA	UJPN U1~4 FUJII, M
UJPN U3 ISHIBASHI	UJPN U3 FUKUSHIMA	UJPN U1~4 WATANABE, Y	UJPN U1~4 ARASHIMA	UJPN U1~4 HIBI		UJPN U3 MIYAZAKI	UJPN U4 HIROSAKA	UJPN U5 KOGA	UJPN U5 YAMAMURA	UJPN U5 UCHIDA
UJPN U5 MIHARA, C	UJPN U5 YADA	UJPN U6 SUZUKI, M	UJPN U6 OUCHI	UJPN U6 MATSUMOTO, E	II	UJPN U6 KOBAYASHI, KI	UJPN U7 SANADA	UJPN U6 MATSUMOTO, E	UJPN U6 TANIGUCHI	UJPN U7 FURUTA
UJPN U7 HARADA	UJPN U7 OTHUKA	UJPN U7 SANADA	UJPN U7 OTHUKA	UJPN U7 MITO		UJPN U1 KANEDA	UJPN U1~4 YAMAZAWA	UJPN U1~4 MASHITA	UJPN U1~4 YAMAMOTO, Y	UJPN U1~4 FUJII, M
UJPN U2 KUBO	UJPN U2 KOBAYASHI, KA	UJPN U1~4 HAYASHI, K	UJPN U2 KOBAYASHI, KA	UJPN U1~4 ARASHIMA	III	UJPN U3 ISHIBASHI	UJPN U3 FUKUSHIMA	UJPN U1~4 YAMAMOTO, O	UJPN U1~4 ARASHIMA	UJPN U1~4 FUJII, M
UJPN U4 MIYAZAKI	UJPN U4 HIROSAKA	UJPN U5 KOGA	UJPN U4 HIROSAKA	UJPN U5 YAMAMURA		UJPN U4 MIYAZAKI	UJPN U5 KOGA	UJPN U5 KOGA	UJPN U5 YAMAMURA	UJPN U5 UCHIDA
UJPN U5 MIHARA, C	UJPN U5 YADA	UJPN U6 SUZUKI, M	UJPN U5 YADA	UJPN U6 MATSUMOTO, E	IV	UJPN U6 KOBAYASHI, KI	UJPN U6 SUZUKI, M	UJPN U6 MATSUMOTO, E	UJPN U6 TANIGUCHI	UJPN U6 TANIGUCHI
UJPN U7 HARADA	UJPN U7 OTHUKA	UJPN U7 SANADA	UJPN U7 OTHUKA	UJPN U7 MITO		UJPN U6 KOBAYASHI, KI	UJPN U7 SANADA	UJPN U7 SANADA	UJPN U7 MITO	UJPN U7 FURUTA
	JC U ONISHI	PHYS U SATO, T	PHYS U ONISHI	MATH U TAKAHASHI	V		PHYS U SHIMODA	MATH U TAKAHASHI	CHEM U ISOBE	
	JC U KOMINAMI	PHYS U SHIMODA	PHYS U KOMINAMI	MATH U TAHARA		UJPN U1 KANEDA	UJPN U1~4 YAMAZAWA	PHYS U TOCHIO	MATH U TAHARA	CHEM U TORIUMI
	JC U MOTOBAYASHI	PHYS U TOCHIO	PHYS U MOTOBAYASHI	MATH U FUJI	UJPN U2 KUBO	UJPN U1~4 HAYASHI, K	PHYS U NAKABE	MATH U FUJI	CHEM U NAITO	
	JC U WATANABE, C	PHYS U NAKABE	PHYS U WATANABE, C	MATH U MIYATA	UJPN U3 ISHIBASHI	UJPN U1~4 WATANABE, Y	PHYS U HANDA, KAT	MATH U MIYATA	CHEM U HONMA	
		BIO U KANAZAWA	PHYS U HANDA, KAT	MATH U MORITA	UJPN U4 MIYAZAKI	UJPN U5 KOGA	BIO U KANAZAWA	MATH U MORITA	CHEM U MATSUMOTO, A	
		BIO U GOTO	BIO U KANAZAWA	MATH U YAMADA	UJPN U5 MIHARA, C	UJPN U6 SUZUKI, M	BIO U GOTO			
			PHYS U SATO, T		UJPN U6 KOBAYASHI, KI	UJPN U7 SANADA				
	UJPN U IMAI	PHYS U SHIMODA	PHYS U IMAI		UJPN U7 HARADA					
	UJPN U KISHIDA	PHYS U TOCHIO	PHYS U KISHIDA							
	UJPN U SHIBATA	PHYS U NAKABE	PHYS U SHIBATA							
	UJPN U SHOJI	PHYS U HANDA, KAT	PHYS U SHOJI							
	UJPN U YAMAKAWA	BIO U KANAZAWA	PHYS U YAMAKAWA							
	UJPN U YAMATO	BIO U GOTO	BIO U YAMATO							
	UJPN U IMAI		UJPN U IMAI							
	UJPN U YAMAKAWA		UJPN U YAMAKAWA							
	UJPN U YAMATO		UJPN U YAMATO							

J

Monday		Tuesday		Wednesday		Thursday		Friday	
B1 RDG 39J102 KANAI	B1 WRT 39J302 LEE	B2 KV 39J624 HARADA	B2 KV 39J626 HARADA	B2 KV 39J626 KITAGAWA	B2 GV 39J528 FUJII_C	B1 KV 39J604 NAKAJIMA			
B2 LIS 39J222 KAWABUCHI	B2 GV 39J524 HARADA	B2 WRT 39J326 HAYASHI_Y	B2 WRT 39J326 HAYASHI_Y	B2 RDG 39J126 KUBOTA	B2 SPK 39J428 FEENER	B2 GV 39J532 OGAWA			
B2 SPK 39J422 TANAKA_Y	B2 RDG 39J124 HAYASHI_Y	C1 WRT 39J344 SUGIYAMA	C1 WRT 39J344 SUGIYAMA	B2 SPK 39J426 OOUE	C1 RDG 39J148 TANAKA_S	C1 LIS 39J254 FURUKAWA			
C1 KV 39J642 YAMAMURA	C1 LIS 39J246 SOGAWA	C1 GV 39J544 NAKATA	C1 GV 39J544 NAKATA	C1 RDG 39J144 NISHIKAWA	C1 WRT 39J350 YUASA	C1 RDG 39J152 HIRANO			
C1 LIS 39J242 CHIDA	C1 SPK 39J444 KASAMATSU	B2 THO 39J708 WATANABE_C	B2 THO 39J708 WATANABE_C	C1 SPK 39J446 TANAKA_M	C1 HIS 39JH24 TAIRA	B2 HIS 39JH12 SATO_S			
B2 THO 39J702 MOTOBAYASHI	B2 THO 39J706 MATSUMURA_etc.	B2 HIS 39J406 SANO	B2 HIS 39J406 SANO	C1 WRT 39J346 MINOKAWA	C1 LIT 39JL24 ADACHI	C1 LIT 39JL24 ADACHI			
B2 RDG 39J122 MATSUSHIMA	B2 KV 39J624 HARADA	B2 WRT 39J326 HAYASHI_Y	B2 WRT 39J326 HAYASHI_Y	B1 GV 39J502 TANAKA_M	B2 LIS 39J228 TANAKA_S	B2 KV 39J632 FURUKAWA			
B2 WRT 39J322 SAKATA	B2 WRT 39J326 HAYASHI_Y	C1 WRT 39J344 SUGIYAMA	C1 WRT 39J344 SUGIYAMA	B2 GV 39J526 IDE	B2 RDG 39J128 FEENER	B2 WRT 39J332 SUZUKI_Y			
C1 RDG 39J142 CHIDA	C1 WRT 39J344 SUGIYAMA	C1 GV 39J544 NAKATA	C1 GV 39J544 NAKATA	B2 LIS 39J224 MINOKAWA	C1 GV 39J548 YAMAZAWA	C1 KV 39J652 ADACHI			
C1 SPK 39J442 OGURA	C1 GV 39J544 NAKATA	B2 THO 39J708 WATANABE_C	B2 THO 39J708 WATANABE_C	C1 KV 39J644 KUBOTA	C1 KV 39J648 HARIMA	C1 GV 39J550 KISHIDA			
C1 CON 39JC22 MOTOBAYASHI	B2 THO 39J708 WATANABE_C	B2 THO 39J708 WATANABE_C	B2 THO 39J708 WATANABE_C	B2 LIS 39J248 IWAI_Y	C1 SPK 39J450 HATANO	B2 LIN 39JN06 TSUTTA			
B2 THO 39J704 KATO	B2 HIS 39J406 SANO	B2 HIS 39J406 SANO	B2 HIS 39J406 SANO	B2 EDU 39JE04 KOMORI	B2 LIT 39JL06 HONDA	C1 LIT 39JL26 MIZUNO			
B2 THO 39J704 KATO	B2 HIS 39J406 SANO	B2 HIS 39J406 SANO	B2 HIS 39J406 SANO	C1 THO 39J722 BURENVA					
A2 RDG 39J100 MIHARA_C	JDR 39J040 IMAI	JDR 39J040 IMAI	JDR 39J040 IMAI	A2 GV 39J500 IDE	A2 SPK 39J400 MITO	A2 KV 39J600 HIGUCHI			
B1 LIS 39J202 NISHIMURA	JDR 39J043 KISHIDA	JDR 39J043 KISHIDA	JDR 39J043 KISHIDA	B1 SPK 39J404 SANADA	B1 WRT 39J304 NAMBA	B1 GV 39J504 MATSUOKA			
B2 GV 39J522 ISHIBASHI	JDR 39J047 SHIBATA	JDR 39J047 SHIBATA	JDR 39J047 SHIBATA	C1 GV 39J546 UEDA	B2 GV 39J530 KOZAKURA	B2 GV 39J534 FURUKAWA			
B2 WRT 39J324 MATSUSHIMA	JDR 39J050 TSUTA	JDR 39J050 TSUTA	JDR 39J050 TSUTA	C1 LIS 39J250 HATANO	B2 KV 39J630 ARASHIMA	B2 LIS 39J232 ATARASHI			
C1 LIS 39J244 IWADE	JDR 39J051 NAKATA	JDR 39J051 NAKATA	JDR 39J051 NAKATA	C1 SPK 39J448 IMADA	B2 RDG 39J130 MASHITA	C1 SPK 39J452 FUJII_M			
C1 WRT 39J342 OGURA	JDR 39J055 YAMAKAWA	JDR 39J055 YAMAKAWA	JDR 39J055 YAMAKAWA	B2 SOC 39JS02 ITO	C1 WRT 39J352 YAMAMOTO_K	B2 EDU 39JE06 SUZUKI_Y			
C1 CON 39JC24 NUKITA	JDR 39J056 YAMATO	JDR 39J056 YAMATO	JDR 39J056 YAMATO	B2 CON 39JC04 IWAI_S	B2 CON 39JC06 LIU_LINGFANG	C1 HIS 39JH30 KOYAMA			
B2 LIT 39JL02 GONOJI	JDR 39J058 SANO	JDR 39J058 SANO	JDR 39J058 SANO	B2 LIN 39JN02 NAKATA	C1 HIS 39JH26 INOMO	C1 LIT 39JL28 SHIBATA			
B2 LIT 39JL02 GONOJI	JDR 39J059 MATSUMURA	JDR 39J059 MATSUMURA	JDR 39J059 MATSUMURA	B2 LIN 39JN02 NAKATA	C1 LIT 39JL22 HONDA				
B1 SPK 39J402 BABA	JDR 39J041 IWAI_S	JDR 39J041 IWAI_S	JDR 39J041 IWAI_S	A2 LIS 39J200 IMADA	A2 WRT 39J300 ATSUTA	B2 SPK 39J432 ATARASHI			
B2 KV 39J622 NISHIMURA	JDR 39J042 IWAI_Y	JDR 39J042 IWAI_Y	JDR 39J042 IWAI_Y	B1 KV 39J602 HIROKAWA	B1 RDG 39J104 NONAKA	C1 GV 39J552 ATSUTA			
C1 GV 39J542 IWADE	JDR 39J044 GONOJI	JDR 39J044 GONOJI	JDR 39J044 GONOJI	B2 KV 39J628 UEDA	B2 WRT 39J330 OSAKI	C1 CON 39JC26 KOYAMA			
B2 CON 39JC02 NUKITA	JDR 39J045 KOMORI	JDR 39J045 KOMORI	JDR 39J045 KOMORI	C1 KV 39J646 KAWASHIMA	C1 RDG 39J150 NAKAJIMA_T	B2 LIN 39JN08 KSHIDA			
B2 HIS 39JH04 FUKUMITSU	JDR 39J046 SANO	JDR 39J046 SANO	JDR 39J046 SANO	B2 WRT 39J328 KOMORI	B2 HIS 39JH10 INOMO	B2 LIT 39JL08 SHIBATA			
B2 LIN 39JN00 YAMAKAWA	JDR 39J048 TAKAI	JDR 39J048 TAKAI	JDR 39J048 TAKAI	B2 RDG 39J146 NAKATA	C1 HIS 39JH28 YAMAMOTO_K	C1 EDU 39JE24 TACHIKAWA			
C1 EDU 39JE22 YAMATO	JDR 39J049 TACHIKAWA	JDR 39J049 TACHIKAWA	JDR 39J049 TACHIKAWA	C1 SOC 39JS04 NAKAMURA	B2 CON 39JC08 BEREZIKOVA_T				
B2 EDU 39JE22 YAMATO	JDR 39J052 MATSUMURA	JDR 39J052 MATSUMURA	JDR 39J052 MATSUMURA	B2 THO 39JT10 MATSUMURA	C1 LIN 39JN26 DUONG				
B2 EDU 39JE22 YAMATO	JDR 39J053 MIZUNO	JDR 39J053 MIZUNO	JDR 39J053 MIZUNO	C1 LIN 39JN24 IWAI_Y					
B2 SPK 39J424 IWADE	JDR 39J054 SHOJI	JDR 39J054 SHOJI	JDR 39J054 SHOJI	B2 LIS 39J226 KAWASHIMA	B1 LIS 39J204 TAKATSUKI				
B2 EDU 39JE02 TAKAI				C1 WRT 39J348 HIROKAWA	B2 LIS 39J230 ATSUTA				
C1 HIS 39JH22 SANO				C1 SOC 39JS22 AOYAMA	B2 SPK 39J430 KONDO				
C1 LIN 39JN22 IMAI				B2 LIN 39JN04 SHOJI	C1 LIS 39J252 OSAKI				
					C1 KV 39J650 NONAKA				

I

II

III

IV

V

M

Monday

Tuesday

Wednesday

Thursday

Friday

A2 MGVβ 395002 395035 395071 395080 395130 395105 395166	MATSUSHIMA KANAI KAWABUCHI TANAKA, Y YAMAMURA CHIDA MOTOBAYASHI	B1 WRT B2 GV B2 RDG C1 LIS C1 SPK B2 CON B2 THO	395045 395386 395086 395107 395117 395200 395168	LEE HARADA HAYASHI, Y SOGAWA KASAMATSU WATANABE, C MATSUMURA etc.	B2 KV B2 RDG B2 SPK C1 RDG C1 SPK C1 WRT HIS	395094 395067 395082 395100 395118 395312 395181	KITAGAWA KUBOTA OUUE NISHIKAWA TANAKA, M MINOKAWA BEKE	B2 GV B2 SPK C1 RDG C1 WRT THO HIS	395388 395083 395102 395314 395165 395176	FUJII, C FEENER TANAKA, S YUASA TAMAS TAIRA	B1 KV B2 GV C1 LIS C1 RDG B2 HIS C1 LIT	395061 395390 395111 395104 395186 395286	NAKAJIMA OGAWA FURUKAWA HIRANO SAITO, S ADACHI
A2 MGVα B1 MGVα1 B1 MGVα2	TAKAI KAWABUCHI TANAKA, Y	A2 MGVα B1 MGVα1 B1 MGVα2	395001 395003 395004	TAGHIKAWA KASAMATSU LEE	A2 MGVβ B1 GV B2 GV B2 LIS C1 KV C1 LIS B2 EDU C1 THO B2 HIS	395002 HATANO 395056 395387 395072 395131 395108 395156 395160 395183	HATANO TANAKA, M IDE MINOKAWA KUBOTA IWAI, Y KOMORI BURENVA SANO	A2 MGVα B1 MGVα1 B1 MGVα2	395001 395003 395004	KOZAKURA NAMBA FUJII, C	A2 MGVα B1 MGVα1 B1 MGVα2	395001 395003 395004	OGAWA NAKAJIMA HIGUCHI
A2 RDG B1 LIS B2 GV B2 WRT C1 LIS C1 WRT C1 CON B2 THO	MIHARA, C NISHIMURA ISHIBASHI MATSUSHIMA IWADE OGURA NUKITA GONOJI	MDR MDR MDR MDR MDR MDR MDR MDR	395220 395221 395222 395223 395224 395225 395226 395227	IWAI, S IWAI, Y GONOJI KOMORI TAKAI TAGHIKAWA MATSUOKA MIZUNO	A2 GV B1 SPK C1 GV C1 LIS C1 SPK B2 SOC B2 CON B2 LIN	395055 395061 395126 395109 395119 395215 395202 395141	IDE SANADA UEDA HATANO IMADA ITO IWAI, S NAKATA	MDR MDR MDR MDR MDR MDR MDR MDR	395025 395046 395389 395096 395069 395315 395203 395177 395285	MITO NAMBA KOZAKURA ARASHIMA MASHITA YAMAMOTO, K LIU LINGFANG INOMO HONDA	A2 KV B1 GV B2 GV B2 LIS C1 SPK B2 EDU C1 HIS C1 LIT	395030 395067 395391 395076 395121 395157 395179 395288	HIGUCHI MATSUOKA FURUKAWA ATARASHI FUJII, M SUZUKI, Y KOYAMA SHIBATA
B1 SPK B2 KV C1 GV B2 CON B2 HIS B2 LIN C1 EDU	BABA NISHIMURA IWADE NUKITA FUKUMITSU YAMAKAWA YAMATO	B1 SPK B2 KV C1 GV B2 CON B2 HIS B2 LIN C1 EDU	395060 395092 395124 395201 395182 395140 395160	BABA NISHIMURA IWADE NUKITA FUKUMITSU YAMAKAWA YAMATO	A2 LIS B1 KV B2 KV C1 KV B2 WRT C1 RDG B2 SOC B2 THO C1 LIN	395015 395060 395095 395132 395378 395101 395216 395170 395136	IMADA HIROKAWA UEDA KAWASHIMA KOMORI NAKATA NAKAMURA MATSUMURA IWAI, Y	A2 WRT B1 RDG B2 WRT C1 RDG B2 HIS C1 HIS B2 CON C1 LIN	395020 395036 395379 395103 395185 395178 395204 395137	ATSUTA NONAKA OSAKI NAKAJIMA, T INOMO YAMAMOTO, K BEREZIKOVA, T DUONG	B2 SPK C1 GV SOC C1 CON B2 LIN B2 LIT C1 EDU	395085 395129 395217 395197 395144 395194 395161	ATARASHI ATSUTA CARMONA KOYAMA AKSHIDA SHIBATA TACHIKAWA
B2 SPK B2 EDU C1 HIS C1 LIN	IWADE FUKUMITSU TAKAI SAWA IMAI	MIS MIS MIS MIS MIS	395230 395231 395232 395233 395234	IWAI, S GONOJI TSUTA MATSUMURA MIZUNO	B2 LIS C1 WRT LIT C1 SOC B2 LIN	395073 395313 395190 395210 395142	KAWASHIMA HIROKAWA CARDI AOYAMA SHOJI	B1 LIS B2 LIS B2 SPK C1 LIS C1 KV	395041 395075 395084 395110 395134	TAKATSUKI ATSUTA KONDO OSAKI NONAKA			

I

II

III

IV

V

F

	Monday			Tuesday			Wednesday			Thursday			Friday		
I	FJPN F2 FJPN F3 B1 RDG B2 LIS B2 SPK C1 KV C1 LIS	OTHUKA YAMAMOTO, O KANAI KAWABUCHI TANAKA, Y YAMAMURA CHIDA	FJPN F2 FJPN F3 WRT GV RDG LIS SPK	- - 39J302 LEE 39J524 HARADA 39J124 HAYASHI, Y 39J246 SOGAWA 39J444 KASAMATSU	FJPN F2 FJPN F3 KV RDG SPK RDG SPK WRT	MIYAZAKI TANAKA, Y KITAGAWA KUBOTA OOUE NISHIKAWA TANAKA, M MINOKAWA	FJPN F2 FJPN F3 GV SPK RDG WRT RDG WRT	39J626 KITAGAWA 39J126 KUBOTA 39J426 OOUE 39J144 NISHIKAWA 39J446 TANAKA, M 39J346 MINOKAWA	FJPN F2 FJPN F3 GV SPK RDG WRT RDG WRT	39J528 FUJII, C 39J428 FEENER 39J148 TANAKA, S 39J350 YUASA	FJPN F2 FJPN F3 KV GV RDG WRT RDG WRT	KOBAYASHI, KA FUKUTOMI FUJII, C FEENER TANAKA, S YAMAZAWA HARIMA HATANO	FJPN F2 FJPN F3 KV WRT KV GV RDG WRT	- - 39J604 NAKAJIMA 39J532 OGAWA 39J254 FURUKAWA 39J152 HIRANO	
II	FJPN F2 FJPN F3 RDG WRT RDG SPK	OTHUKA YAMAMOTO, O MATSUSHIMA SAKATA CHIDA OGURA	FJPN F2 FJPN F3 KV WRT WRT GV	- - 39J624 HARADA 39J326 HAYASHI, Y 39J344 SUGIYAMA 39J544 NAKATA	FJPN F2 FJPN F3 GV WRT LIS LIS	MIYAZAKI TANAKA, Y TANAKA, M IDE MINOKAWA KUBOTA IWAI, Y	FJPN F2 FJPN F3 LIS RDG LIS WRT LIS	39J502 TANAKA, S 39J526 FEENER 39J224 MINOKAWA 39J644 KUBOTA 39J248 IWAI, Y	FJPN F2 FJPN F3 LIS RDG GV KV SPK	39J228 TANAKA, S 39J128 FEENER 39J548 YAMAZAWA 39J648 HARIMA 39J450 HATANO	FJPN F2 FJPN F3 KV WRT KV GV	KOBAYASHI, KA FUKUTOMI TANAKA, S FEENER YAMAZAWA HARIMA HATANO	FJPN F2 FJPN F3 KV WRT KV GV	- - 39J632 FURUKAWA 39J332 SUZUKI, Y 39J652 ADACHI 39J550 KISHIDA	
III	FJPN F3 MATH PHYS RDG LIS GV WRT LIS WRT	YAMAMOTO, O FUJI OZAWA MIHARA, C NISHIMURA ISHIBASHI MATSUSHIMA IWADE OGURA	FJPN F3 FJPN F1 MATH GV SPK GV LIS SPK	- - SHOJI	39FPO2 KUBOTA 39FMIN2 SAKANE 39J500 IDE 39J404 SANADA 39J546 UEDA 39J250 HATANO 39J448 IMADA	FJPN F3 POLI MATH GV SPK GV LIS SPK	TANAKA, Y KUBOTA SAKANE IDE SANADA UEDA HATANO IMADA	FJPN F3 CHEM SPK WRT GV KV RDG WRT	39FCE2 NAITO 39J400 MITO 39J304 NAMBA 39J530 KOZAKURA 39J630 ARASHIMA 39J130 MASHITA 39J352 YAMAMOTO, K	FJPN F3 HIST KV GV GV LIS SPK	- - 39FH02 INOUE, N 39J600 HIGUCHI 39J504 MATSUOKA 39J534 FURUKAWA 39J232 ATARASHI 39J452 FUJII, M	FJPN F3 HIST SPK GV	INOUE, N ATARASHI ATSUTA		
IV	MATH MATH PHYS SPK KV GV	MORITA FUJI OZAWA BABA NISHIMURA IWADE	JC FJPN F2-3 MATH LIS KV KV KV WRT RDG	39FJC2 ONISHI - TSUTA	39FPO2 IMURA 39FMIN2 SAKANE 39J200 IMADA 39J602 HIROKAWA 39J628 UEDA 39J646 KAWASHIMA 39J328 KOMORI 39J146 NAKATA	POLI MATH LIS KV KV WRT RDG	IMURA SAKANE IMADA HIROKAWA UEDA KAWASHIMA KOMORI NAKATA	CHEM WRT RDG WRT RDG	39FCE2 NAITO 39J300 ATSUTA 39J104 NONAKA 39J330 OSAKI 39J150 NAKAJIMA, T	HIST SPK GV	39FH02 INOUE, N 39J432 ATARASHI 39J552 ATSUTA				
V	MATH F2-3 SPK J/M/F	MORITA IWADE	B2 LIS C1 WRT	39J226 KAWASHIMA 39J348 HIROKAWA	B2 LIS B2 LIS B2 SPK C1 LIS C1 KV	TAKATSUKI ATSUTA KONDO OSAKI NONAKA									

My Weekly Schedule

	Monday	Tuesday	Wednesday	Thursday	Friday
I					
II					
III					
IV					
V					

略号 / Abbreviations

プログラム/Programs	
【U】	Undergraduate Students Program
【J】	Japanese Studies Program
【M】	Maple Program
【F】	OU Foundation Program

日本語レベル/Japanese Levels	
A2	初中級/Pre-intermediate
B1	中級/Intermediate
B2	中上級/Upper-intermediate
C1	上級/Advanced

授業科目/Subjects for 【J】 【M】 【F】 Program	
日本語実習科目/Japanese Language Subjects	
RDG	読解/Reading
LIS	聴解/Listening
WRT	文章表現/Writing
SPK	口頭表現/Speaking
GV	文法・語彙/Grammar & Vocabulary
KV	漢字・語彙/Kanji & Vocabulary
JWRT	J文章表現/Writing for 【J】 Program Students
MGV	現代日本語初中級文法・語彙/現代日本語中級文法・語彙/Grammar & Vocabulary for 【M】 Program Students
研究科目/Research Subjects	
LIN	日本語学研究基礎/日本語学研究/Japanese Linguistics
EDU	日本語教育学研究基礎/日本語教育学研究/Japanese Language Education
THO	日本思想文化学研究基礎/日本思想文化学研究/Japanese Thought
HIS	日本歴史文化学研究基礎/日本歴史文化学研究/Japanese History
LIT	日本文献文化学研究基礎/日本文献文化学研究/Japanese Literature
CON	日本近現代文化学研究基礎/日本近現代文化学研究/Japanese Contemporary Culture
SOC	日本社会文化学研究基礎/日本社会文化学研究/Japanese Social Sciences
専門演習科目/Seminar Subjects	
JDR	日本語・日本文化研究指導/日本語・日本文化研修指導/Directed Research and Reading for 【J】 Program Students
MDR	日本語日本文化専門演習/Directed Research and Reading for 【M】 Program Students
MIS	自主研究/Independent Studies for 【M】 Program Students

授業科目/Subjects for 【U】 【F】 Program	
UJPN	学部留学生日本語/Japanese for 【U】 Program Students
FJPN	OU学部留学生日本語/Japanese for 【F】 Program Students
BIOL	生物/Biology
CHEM	化学/Chemistry
HIST	日本史/History
JC	日本事情/Japanese Cultural Background
MATH	数学/Mathematics
PHYS	物理/Physics
POLI	政治・経済/Politics & Economics

みのお
箕面キャンパスマップ
Minoh Campus Map

箕面キャンパスマップ Minoh Campus Map

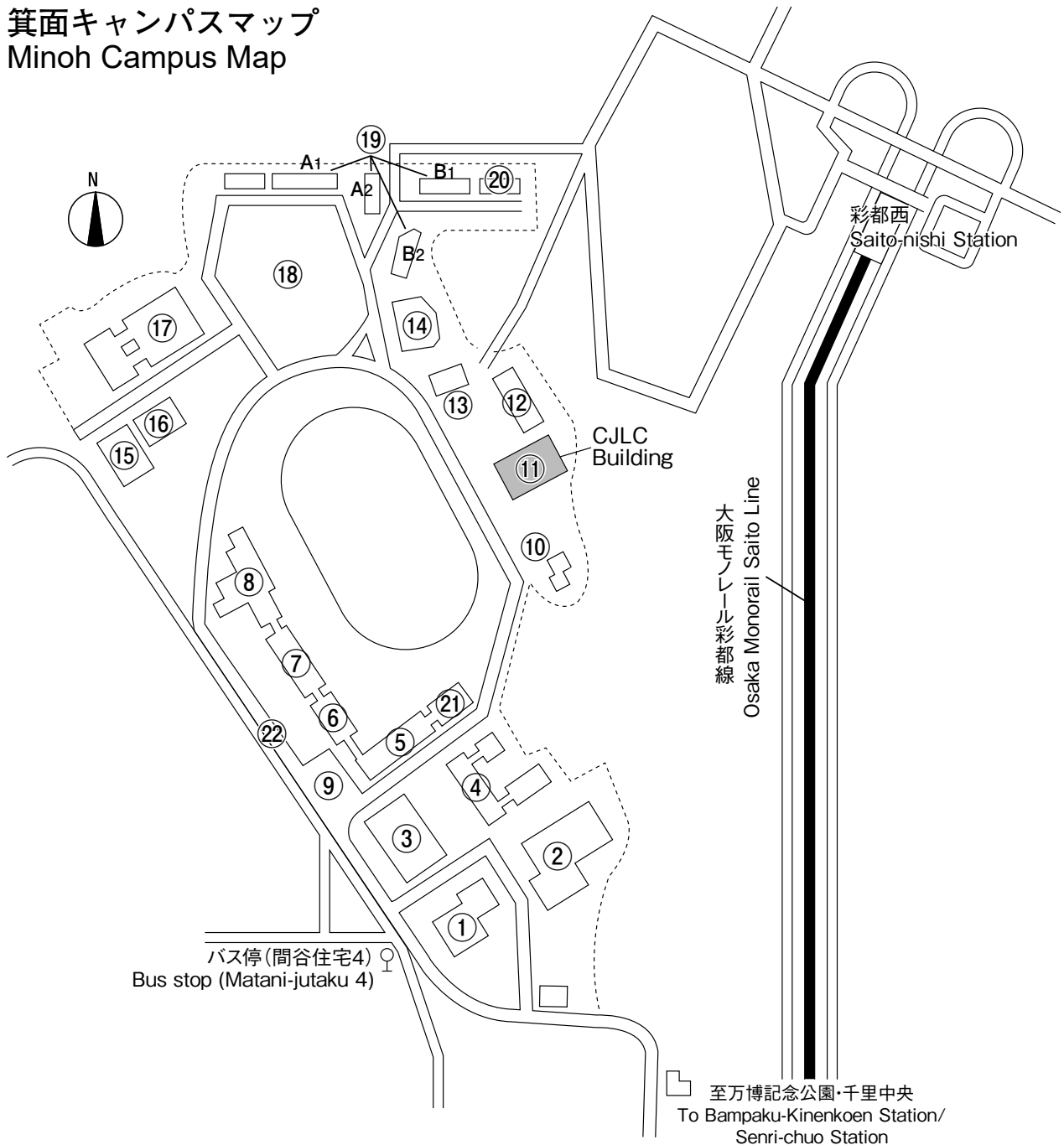

○利用交通機関

[モノレール] 大阪モノレール : 彩都西駅下車 徒歩約 15 分

[バス] 阪急バス : 千里中央発「阪大外国語学部前行」、「間谷住宅行」

阪急バス : 北千里発「阪大外国語学部前行」、「間谷住宅行」

阪急バス : 箕面 (阪急箕面駅) 発「間谷住宅行※」

いずれも、阪大外国語学部前または間谷住宅 4 下車 徒歩すぐ

なお、土・日・祝日及び春期／夏期／冬期休業期間については、千里中央発 (北千里経由) 「阪大外国語学部前行」は運休となりますので「間谷住宅行」をご利用ください。

(※印の路線は運行本数が少ないので注意してください。)

○ How to get to Minoh Campus

[Monorail] Osaka Monorail : 15 minute walk from Saito-nishi Station

[Bus] Hankyu Bus (from Senri-chuo Station) : Take the bus bound for “Handai-gaikokugo-gakubu-mae” or “Matani-jutaku”

Hankyu Bus (from Kita-senri Station) : Take the bus bound for “Handai-gaikokugo-gakubu-mae” or “Matani-jutaku”

Hankyu Bus (from Minoh Station) : Take the bus bound for “Matani-jutaku” (note 1)

Get off at “Handai-gaikokugo-gakubu-mae” or “Matani-jutaku 4”, from where it is a short walk to Minoh Campus.

The bus bound for “Handai-gaikokugo-gakubu-mae” from Senri-chuo Station (via Kita-senri Station) does not run on Saturdays, Sundays, holidays and during spring/summer/winter vacation, and so take the bus bound for “Matani-jutaku” to get to Minoh Campus.

(note 1): Please be careful as the number of buses leaving from Minoh Station is very few.

番号 Number	施設 Facility
①	管理棟 Administration Building
②	箕面福利会館 Minoh Cafeteria & University Bookstore
③	外国学図書館 International Studies Library
④	研究・講義棟 (A 棟) Classrooms and Faculty Offices (Building A)
⑤	研究・講義棟 (B 棟) ※ Classrooms and Faculty Offices (Building B) ※
⑥	研究・講義棟 (C 棟) Classrooms and Faculty Offices (Building C)
⑦	研究・講義棟 (D 棟) Classrooms and Faculty Offices (Building D)
⑧	研究・講義棟 (E 棟) Classrooms and Faculty Offices (Building E)
⑨	バスターミナル Bus Terminal
⑩	記念会館 Memorial Hall
⑪	日本語日本文化教育センター棟 Center for Japanese Language and Culture Building
⑫	サークル共用施設 Extracurricular Activities Facilities
⑬	箕面留学生会館 2 号館 Minoh Dormitory for Foreign Students: Building 2
⑭	箕面留学生会館 1 号館 Minoh Dormitory for Foreign Students: Building 1
⑮	ハンドボールコート Handball field
⑯	プール Swimming Pool
⑰	体育館 Gymnasium
⑱	テニスコート Tennis Court
⑲	学生寮 (A1, A2, B1, B2) Dormitories for Students
⑳	箕面国際学生宿舎 Minoh International Student House
㉑	総合研究棟 General Research Building
㉒	学内連絡バス停留所 School Bus Stop (Inter-campus Shuttle Bus Service)

※国際教育交流センター箕面分室 (1 階)

Center for International Education and Exchange, Minoh Branch (1st floor)

日本語日本文化教育センター棟
CJLC Building

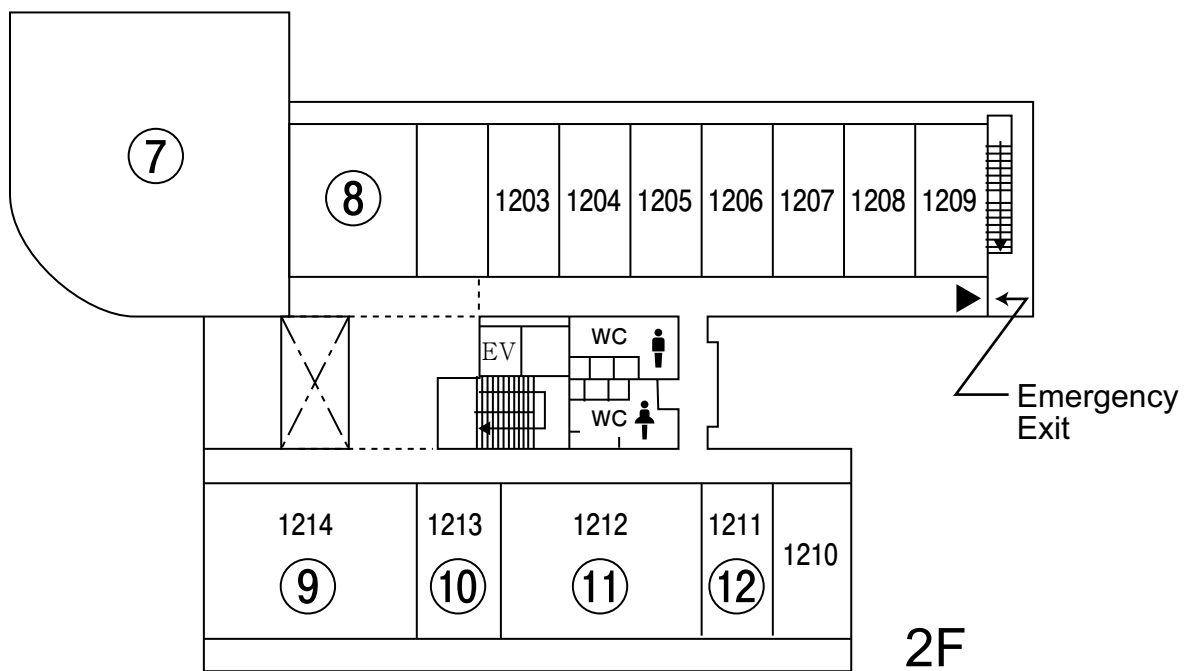
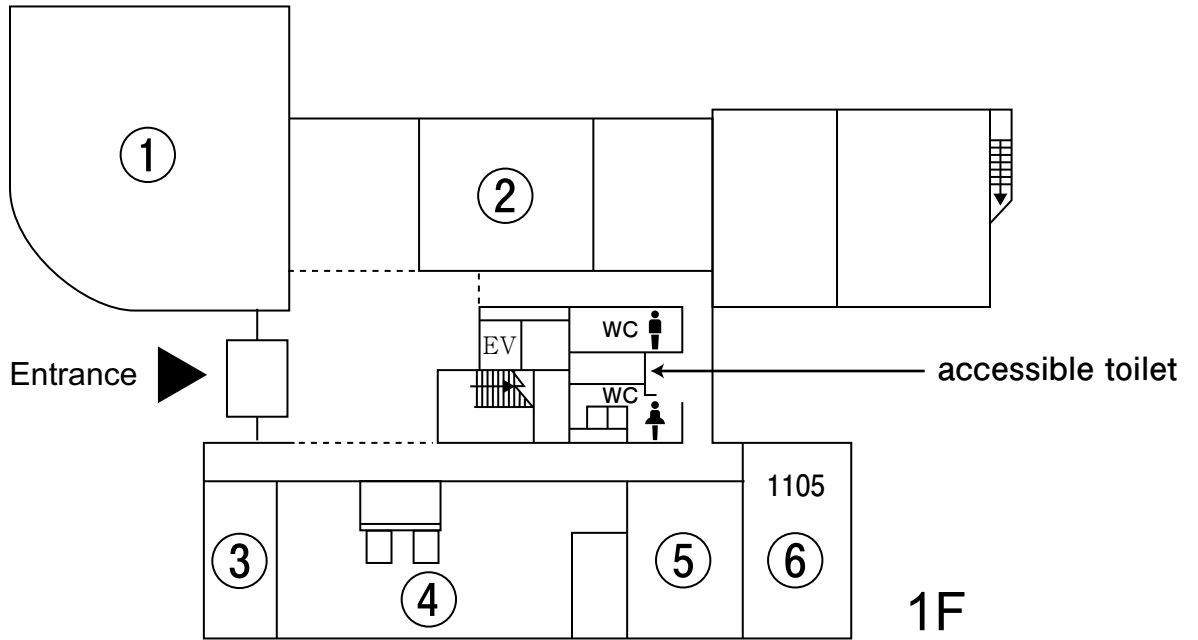

番号 Number	施設 Facility
①	多目的ホール CJLC Hall
②	講師控室 Instructors' Lounge
③	客員教員室 Guest Faculty Room
④	CJLC 事務室 CJLC Office
⑤	応接室 Reception Office
⑥	センター長室 Director's Office
⑦	センター図書室 CJLC Library Room
⑧	コンピュータラウンジ Computer Lounge
⑨	LL 実習室 Language Laboratory
⑩	授業見学室 Observation Room
⑪	マルチメディア教室 Multimedia Classroom
⑫	コンピュータ小教室 Computer Room

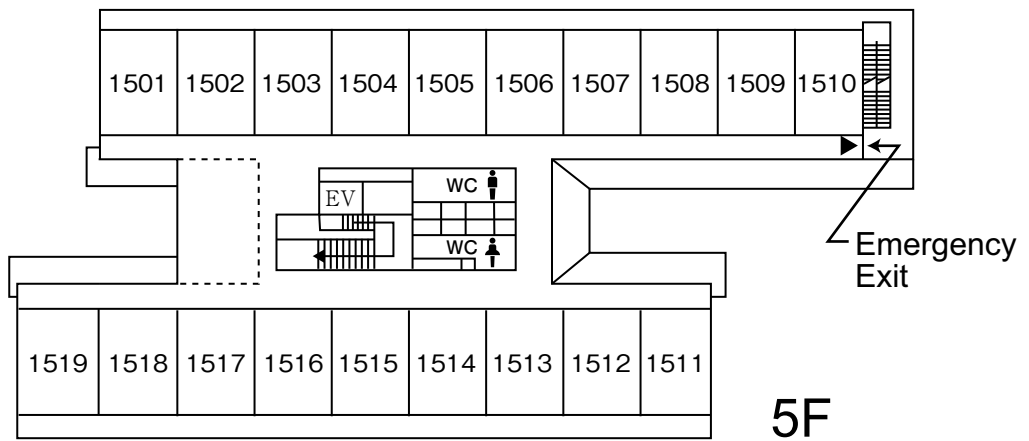
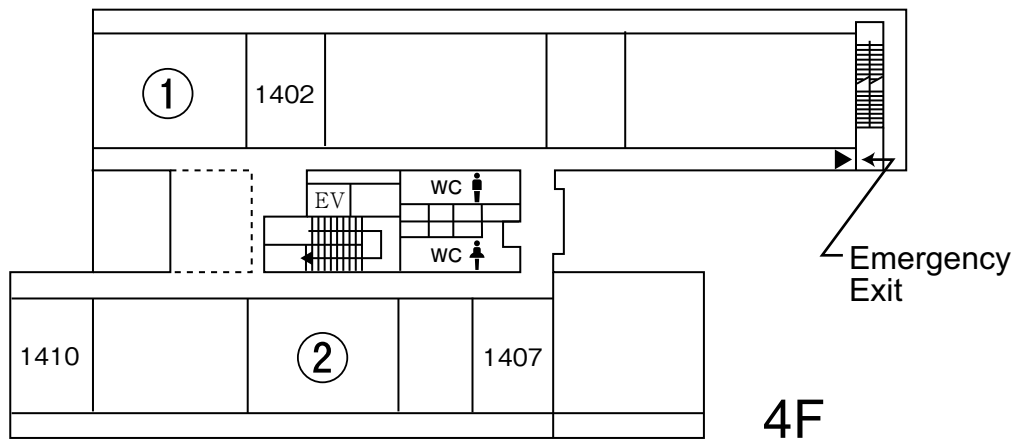
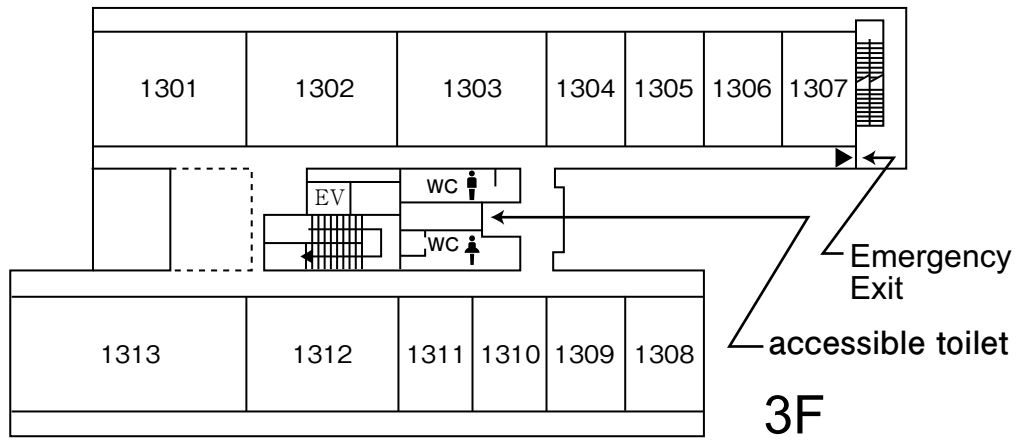

番号 Number	施設 Facility
①	共同研究室 1 CJLC Faculty Room 1
②	共同研究室 2 CJLC Faculty Room 2

※ 教員研究室
Instructors' Offices

部屋番号 Room Number	教員名 Instructor's Name	部屋番号 Room Number	教員名 Instructor's Name
1105	加藤 均 KATO H.	1509	大和 祐子 YAMATO Y.
1402	立川 真紀絵 TACHIKAWA M.	1510	佐野 方郁 SANO M.
1407	ベレジコワ タチアナ BEREZIKOVA, T. ベーケーリサ BEKE, L.	1511	今井 忍 IMAI S.
1410	藤平 愛美 FUJIHIRA M. 松岡 里奈 MATSUOKA R.	1512	荘司 育子 SHOJI I.
1501	五之治 昌比呂 GONOJI M.	1513	岸田 泰浩 KISHIDA Y.
1502	小森 万里 KOMORI M.	1514	松村 薫子 MATSUMURA K.
1504	水野 亜紀子 MIZUNO A.	1515	岩井 康雄 IWAI Y.
1505	村田 真実 MURATA M.	1516	中田 一志 NAKATA H.
1506	蔦 清行 TSUTA K.	1517	ズオンティ ホア DUONG, T. ブレニナ ユリア BURENINA, Y.
1507	高井 美穂 TAKAI M.	1518	岩井 茂樹 IWAI S.
1508	山川 太 YAMAKAWA F.	1519	柴田 芳成 SHIBATA Y.

アドバイザー / Advisors

[U] Program	
U1 } U7	YAMATO Y. KISHIDA Y. IMAI S. SHOJI I. SHIBATA Y. YAMAKAWA F.

[J] Program	
	MATSUMURA K. SHIBATA Y. YAMAKAWA F. SANO M. MIZUNO A. TACHIKAWA M.

[M] Program	
M1 } M8	KOMORI M. IWAI Y. GONOJI M. IWAI S. MIZUNO A. TAKAI M. TACHIKAWA M. MATSUOKA R.

[F] Program	
F1 } F3	TSUTA K. SHOJI I.

発 行 令和 2 年 9 月

Published in September, 2020

編 集 大阪大学日本語日本文化教育センター

Edited by Center for Japanese Language and Culture,
Osaka University

〒562-8558 大阪府箕面市粟生間谷東 8 丁目 1 番 1 号

8-1-1, Aomatani-higashi, Minoh, Osaka

Phone (072) 730-5075, 5072

(日本語日本文化教育センター事務室)

<http://www.cjlc.osaka-u.ac.jp/>

Email cjlc@office.osaka-u.ac.jp